

TOWER CASE(AGWH2) ASSEMBLY INSTRUCTION

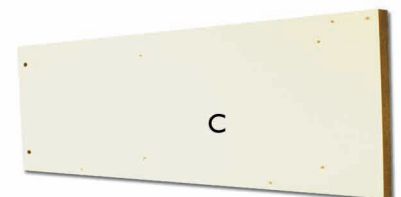

NOTE: Must have two persons assemble this unit.

PARTS LIST

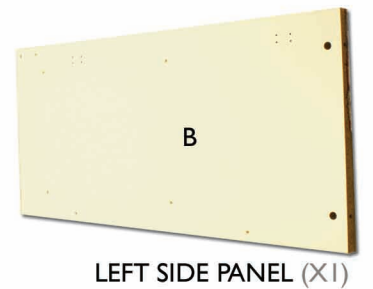
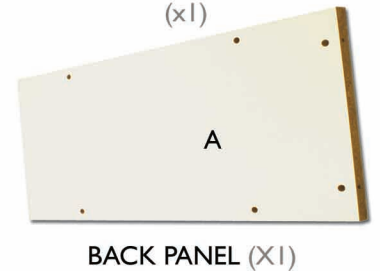
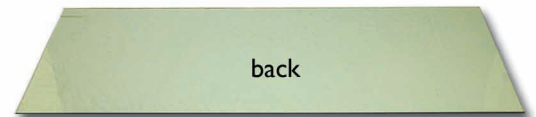
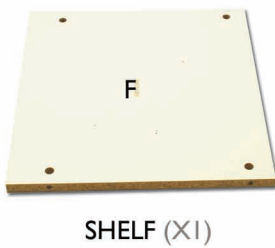
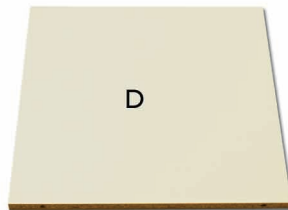
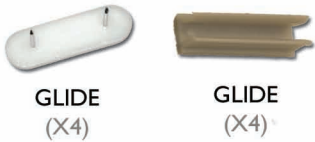
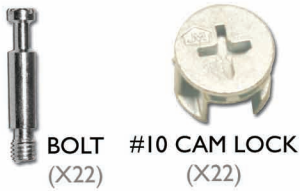
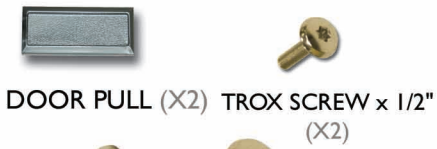

TOOLS NEEDED



*T20 TROX SCREW DRIVER NEEDED

I.

BASE ASSEMBLE

TOE KICK (x1)
LEFT SIDE PANEL (x1)
RIGHT SIDE PANEL (x1)
BACK PANEL (x1)
BOTTOM PANEL (x1)

TOP PANEL (x1)
SHELF PANEL (x1)
BOLT (x22)
#58 CAM LOCK (x22)
GLIDE (x4)

1. CONNECT BACK PANEL WITH RIGHT SIDE PANEL USING BOLT.
2. INSERT AND TIGHTEN #58 CAM LOCK.
3. CONNECT FALSE BOTTOM PANEL WITH RIGHT SIDE PANEL USING BOLT.
4. INSERT AND TIGHTEN #58 CAM LOCK.
5. CONNECT TOEKICK PANEL WITH RIGHT SIDE PANEL USING BOLT.
6. INSERT AND TIGHTEN #58 CAM LOCK.
7. CONNECT SHELF PANEL WITH RIGHT SIDE PANEL USING BOLT.
8. INSERT AND TIGHTEN #58 CAMx LOCK.
9. CONNECT LEFT SIDE PANEL WITH ASSEMBLED BASE USING BOLT.
10. INSERT AND TIGHTEN #58 CAM LOCK.
11. ATTACH GLIDES ON TOEKICK.
12. SIT ASSEMBLED BASE ON FLOOR.
13. ATTACH BOTTOM PANEL WITH ASSEMBLED BASE USING BOLT.

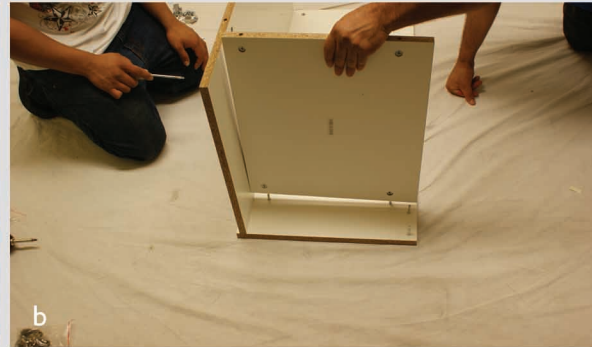

2.

STORAGE ASSEMBLE

DOOR PANEL (x2)
HINGE (x2)
DOOR KNOB (x1)
#6 x 1/2" PAN SCREW(x12)

1. ATTACH HINGE TO DOOR PANEL USING #6 x 1/2" PAN SCREW.
2. ATTACH DOOR KNOB TO DOOR PANEL .
3. CONNECT DOOR WITH LEFT SIDE PANEL USING #6 x 1/2" PAN SCREW.

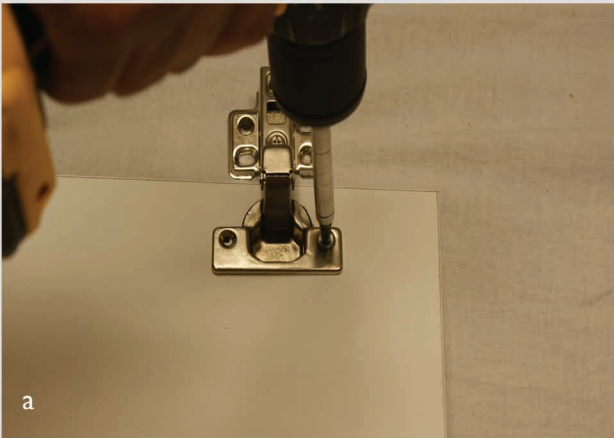

3.

GLASS MODULAR ASSEMBLE

BACK GLASS (x1)
LEFT SIDE GLASS (x1)
RIGHT SIDE GLASS (x1)
TOP GLASS (x1)
AGCON2 (x6)
AGCON3 (x2)
#6 x 1/2" PAN SCREW (x4)
TROX SCREW x 3/4" (x24)
SHELF SUPPORT (x8)

1. INSERT BACK GLASS.
2. INSERT LEFT SIDE GLASS .
3. CONNECT FRONT GLASS WITH RIGHT SIDE GLASS USING AGCON3 & 3/4"L TROX SCREW.
4. CONNECT LEFT SIDE GLASS WITH BOTTOM USING AGCON2, 3/4"L TROX SCREW & #6X 1/2 PAN SCREW.
5. REPEAT SETP 3 AND 4. TO CONNECT RIGHT SIDE GLASS WITH BACK GLASS.
6. CONNECT TROX SCREW 3/4" THROUGH SIDE GLASS WITH SHELF SUPPORT.
7. CONNECT TOP GLASS WITH MODULAR USING 3/4" TROX SCREW.

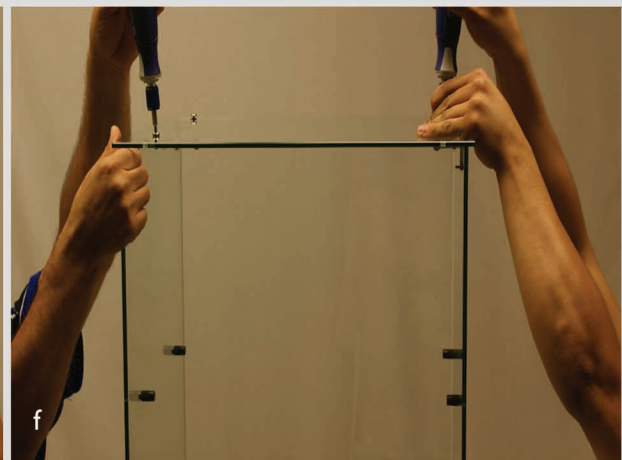
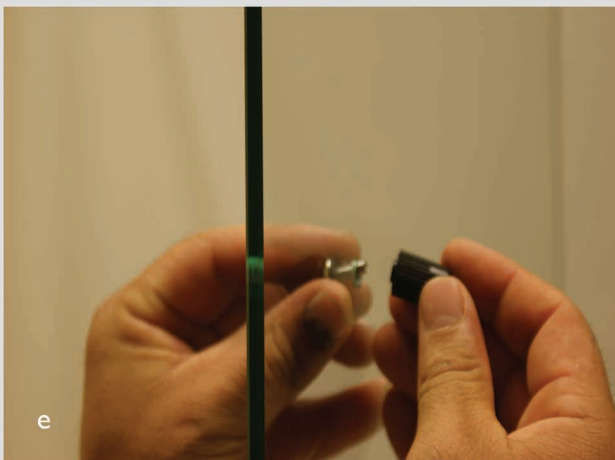
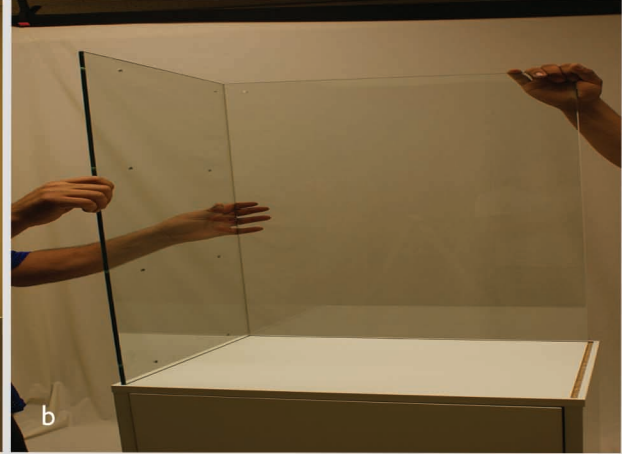
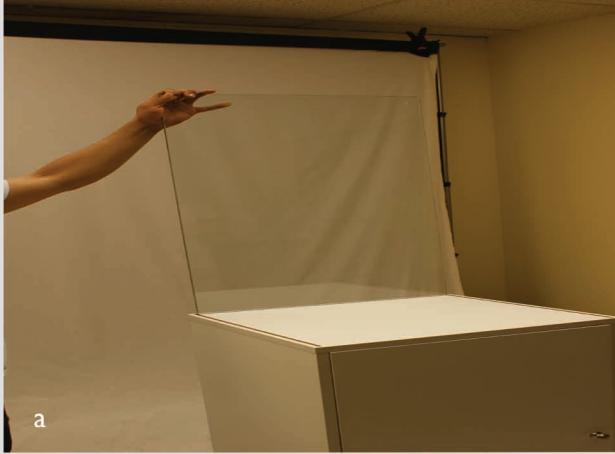

4.

GLASS DOOR ASSEMBLE

GLASS DOOR (x2) TROX SCREW x 1/2" (x2)
HW117-2 (x1) GLASS GLAZING (x4)
HW116-2 (x1) TOP GUIDE (x4)
HW18-2 (x1) DOOR PULL (x2)
NE09034-4 (x2)
#6 x 1/2" PAN SCREW (x2)

1. CONNECT HW117-2 WITH TOP GLASS USING TROX SCREW x 1/2".
2. CONNECT HW116-2 WITH BOTTOM USING #6 x 1/2" PAN SCREW
3. SNAP HW18-2 INTO HW116-2.
4. ATTACH 2 GLASS GLAZING ON 24"L EDGE OF GLASS DOOR.
5. ATTACH NE09034-2 WITH GLASS DOOR.
6. ATTACH 2 TOP GUIDE ON TOP OF GLASS DOOR.
7. PLACE GLASS SHELF ON TO SHELF SUPPORT.
8. INSERT GLASS DOOR ON CASE.
9. ADHERE DOOR PULL ON GLASS DOOR WITH PROPER POSITION.

