

# ASSEMBLY INSTRUCTIONS MANUAL

## 65847 65848 - LED LIGHT KIT FOR 48" & 70" ECONOMY FULL VISION SHOWCASE

**NOTE - WHEN INSTALLING THE LED LIGHT  
FIXTURE INSIDE OF FRAMELESS OR ALL GLASS  
SHOWCASES, IT IS RECOMMENDED TO USE  
CLEAR, DOUBLE SIDED, HEAVY DUTY MOUNTING  
TAP INSTEAD OF DRILLING INTO THE TOP OF  
THE GLASS.**

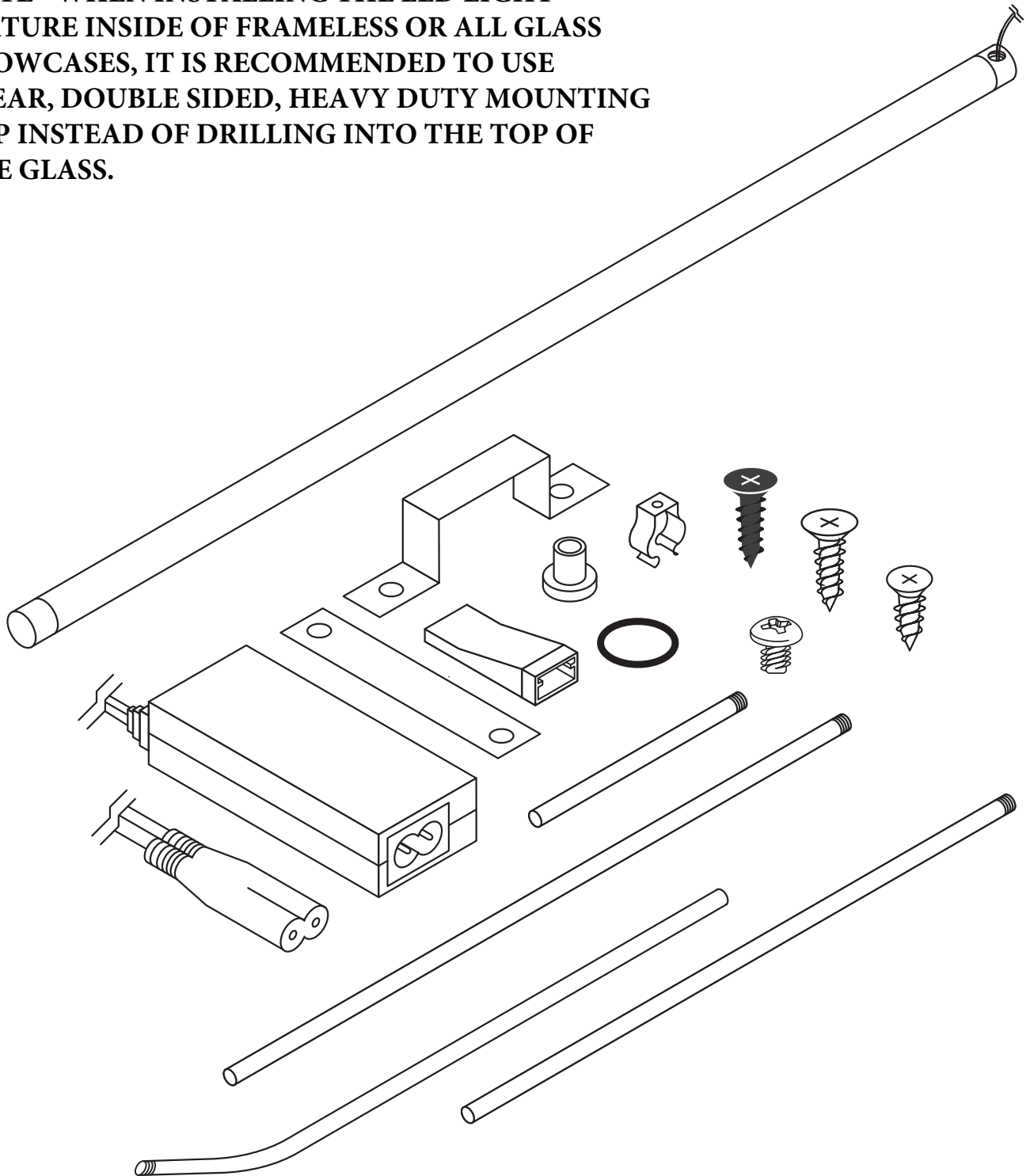

# ASSEMBLY INSTRUCTIONS MANUAL

## 65847 65848 - LED LIGHT KIT FOR 48" & 70" ECONOMY FULL VISION SHOWCASE

### PARTS IN CARTON:

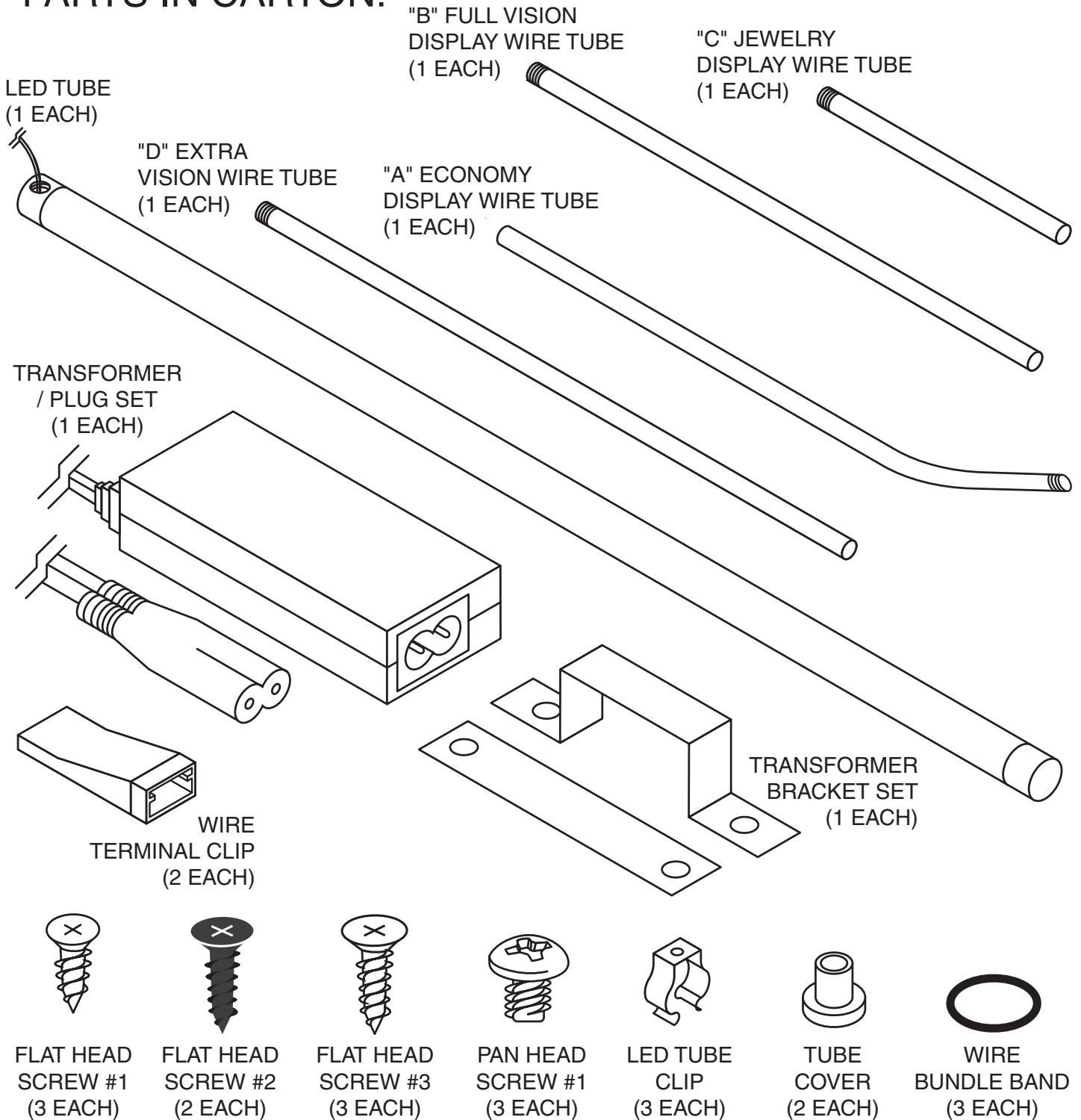

YOU WILL NEED TO SUPPLY YOUR OWN DRILL OR SCREWDRIVER  
FOR INSTALLATION.

# ASSEMBLY INSTRUCTIONS MANUAL

## 65847 65848 - LED LIGHT KIT FOR 48" & 70" ECONOMY FULL VISION SHOWCASE

### STEP 1

PLACE TUBE CLIP INTO PLACE, APPROX. 2IN FROM CORNER, AND TIGHTEN SCREW. REPEAT IN THE MIDDLE, AND ON OPPOSITE CORNER.

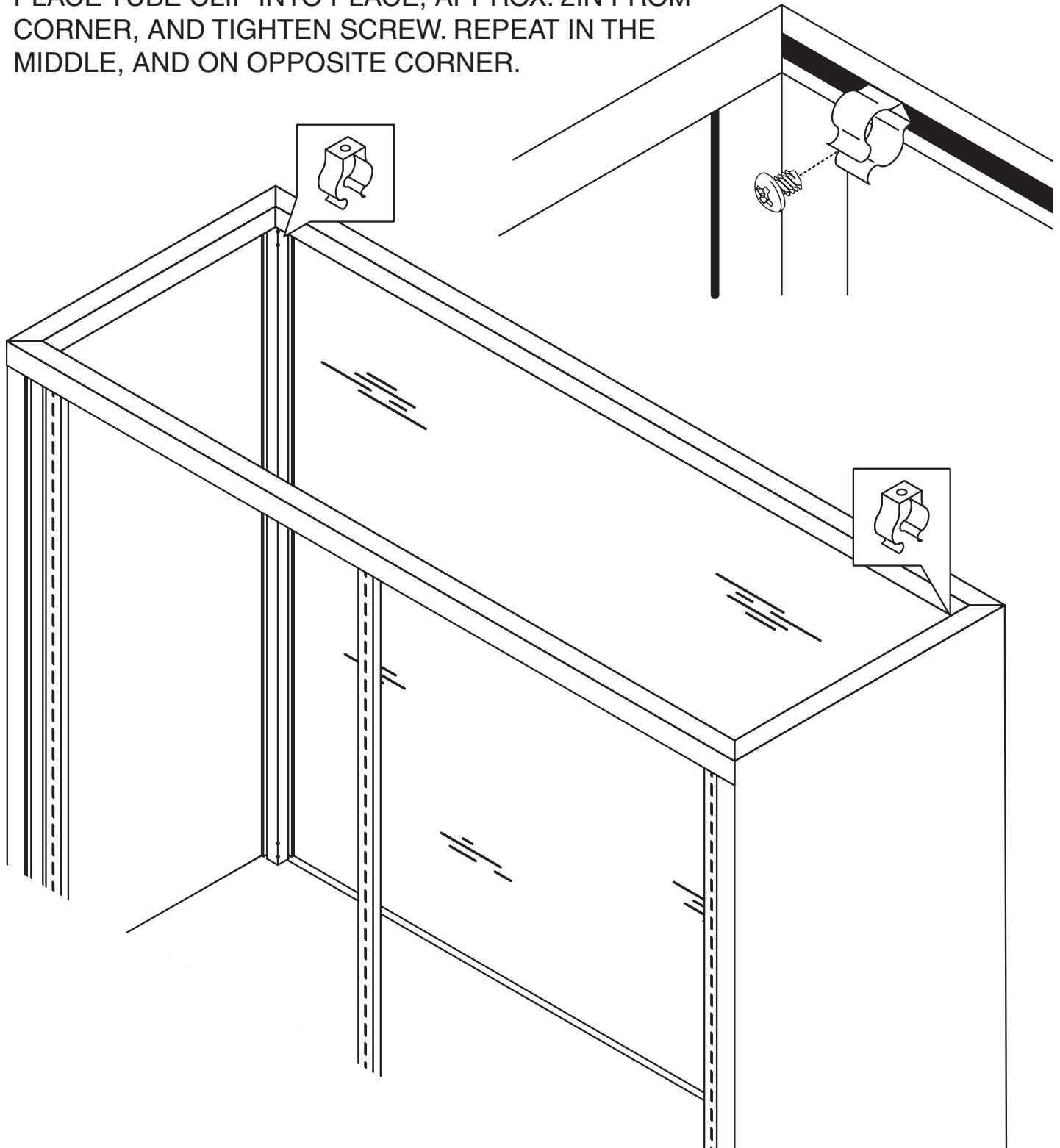

# ASSEMBLY INSTRUCTIONS MANUAL

## 65847 65848 - LED LIGHT KIT FOR 48" & 70" ECONOMY FULL VISION SHOWCASE

### STEP 2

TAKE THE WIRES FROM THE LED BAR AND THREAD THEM THROUGH THE "A" ECONOMY VISION WIRE TUBE, **STARTING FROM THE THREADED END OF THE TUBE.**

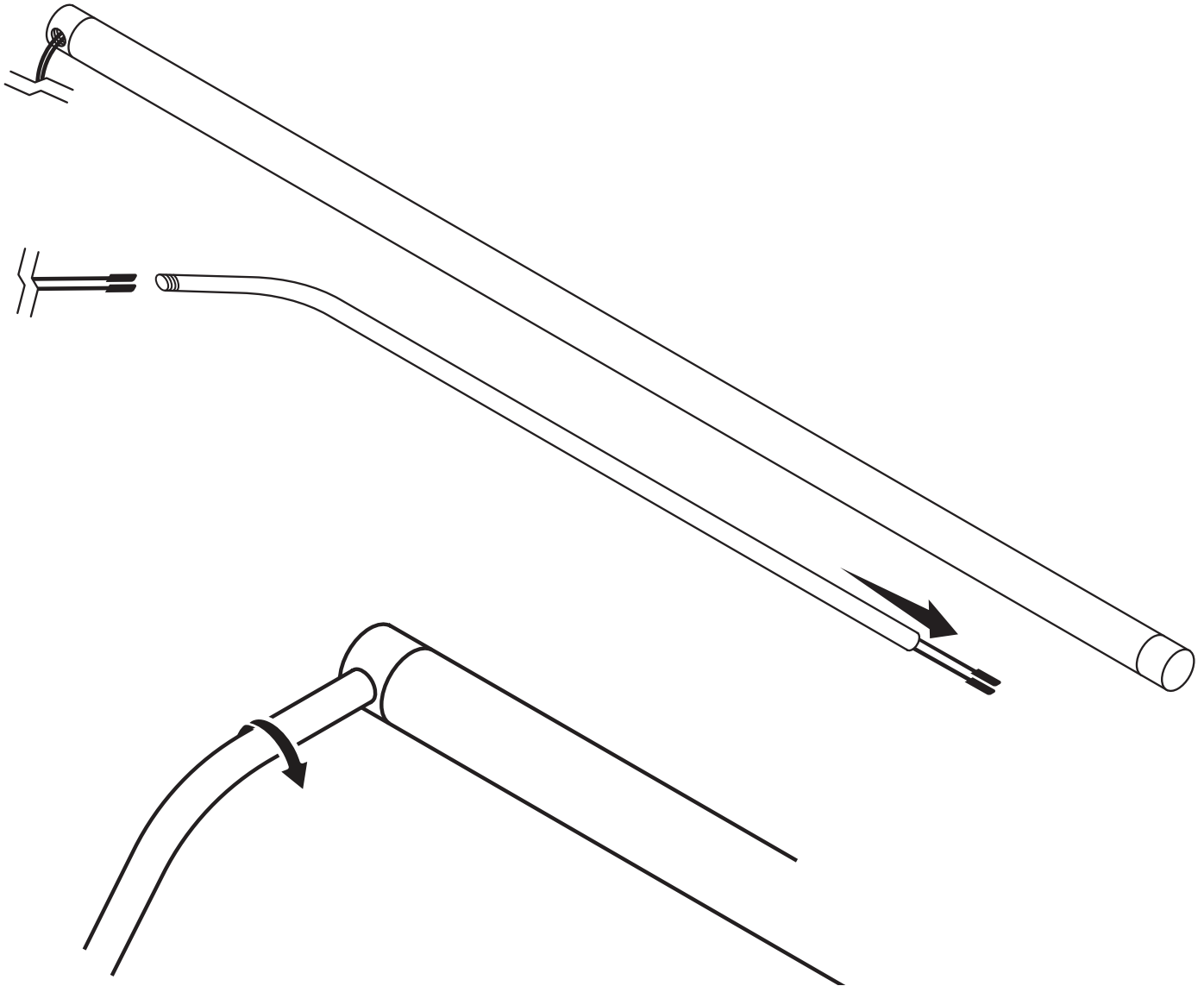

### STEP 3

NEXT, SCREW IN THREADED END OF THE "A" TUBE INTO THE LED TUBE.

# ASSEMBLY INSTRUCTIONS MANUAL

## 65847 65848 - LED LIGHT KIT FOR 48" & 70" ECONOMY FULL VISION SHOWCASE

### STEP 4

PLACE THE TUBE COVER INTO THE PRE-DRILLED HOLE, LOCATED IN THE FRONT CORNER OF THE DISPLAY.

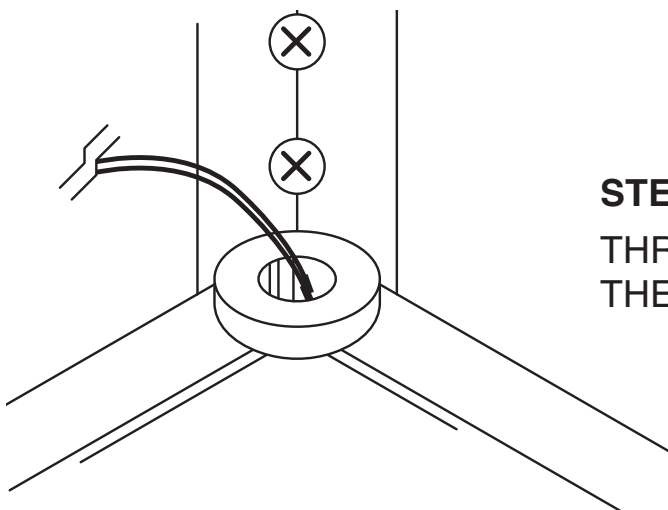
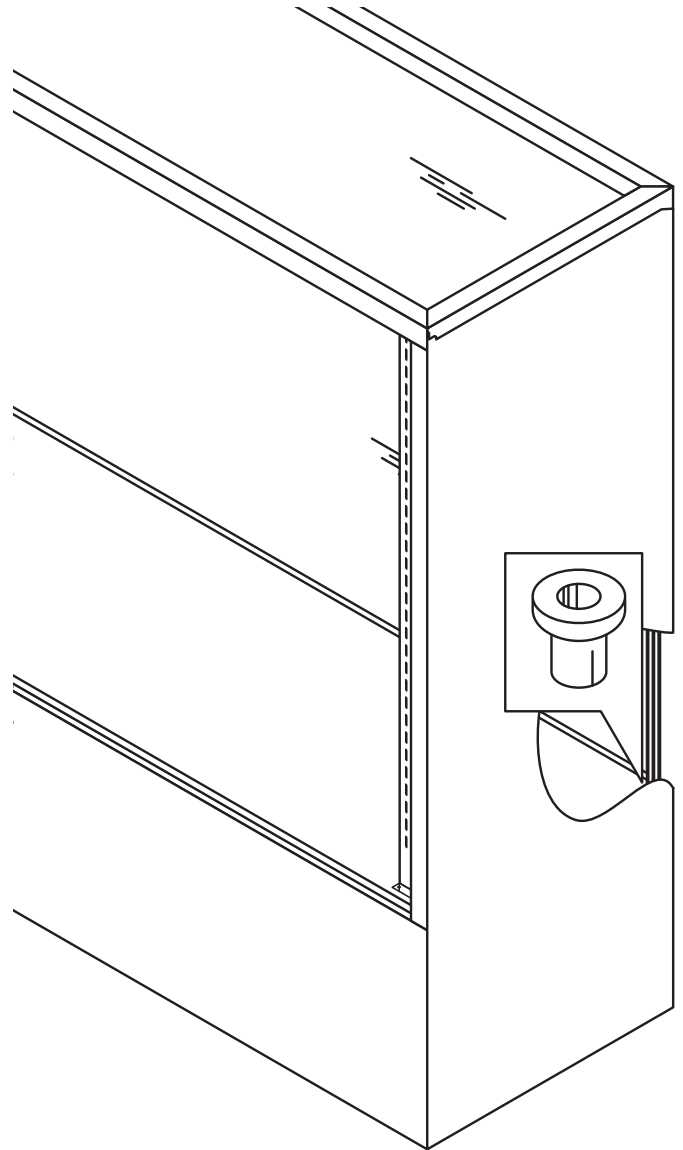
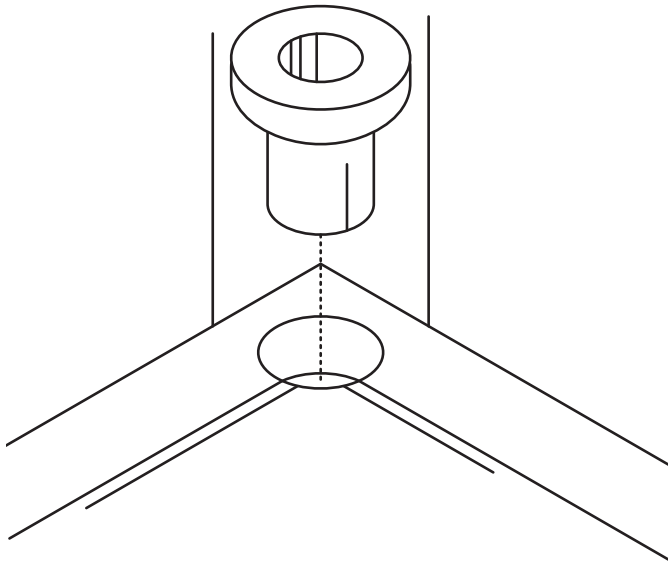

### STEP 5

THREAD THE EXCESS LED WIRE THROUGH THE TUBE COVER.

# ASSEMBLY INSTRUCTIONS MANUAL

## 65847 65848 - LED LIGHT KIT FOR 48" & 70" ECONOMY FULL VISION SHOWCASE

### STEP 6

CAREFULLY SLIDE IN THE LED TUBE ASSEMBLY INTO THE DISPLAY. ALIGN WIRE TUBE WITH TUBE COVER, SLIDE IN AND CLIP LED TUBE INTO PLACE.

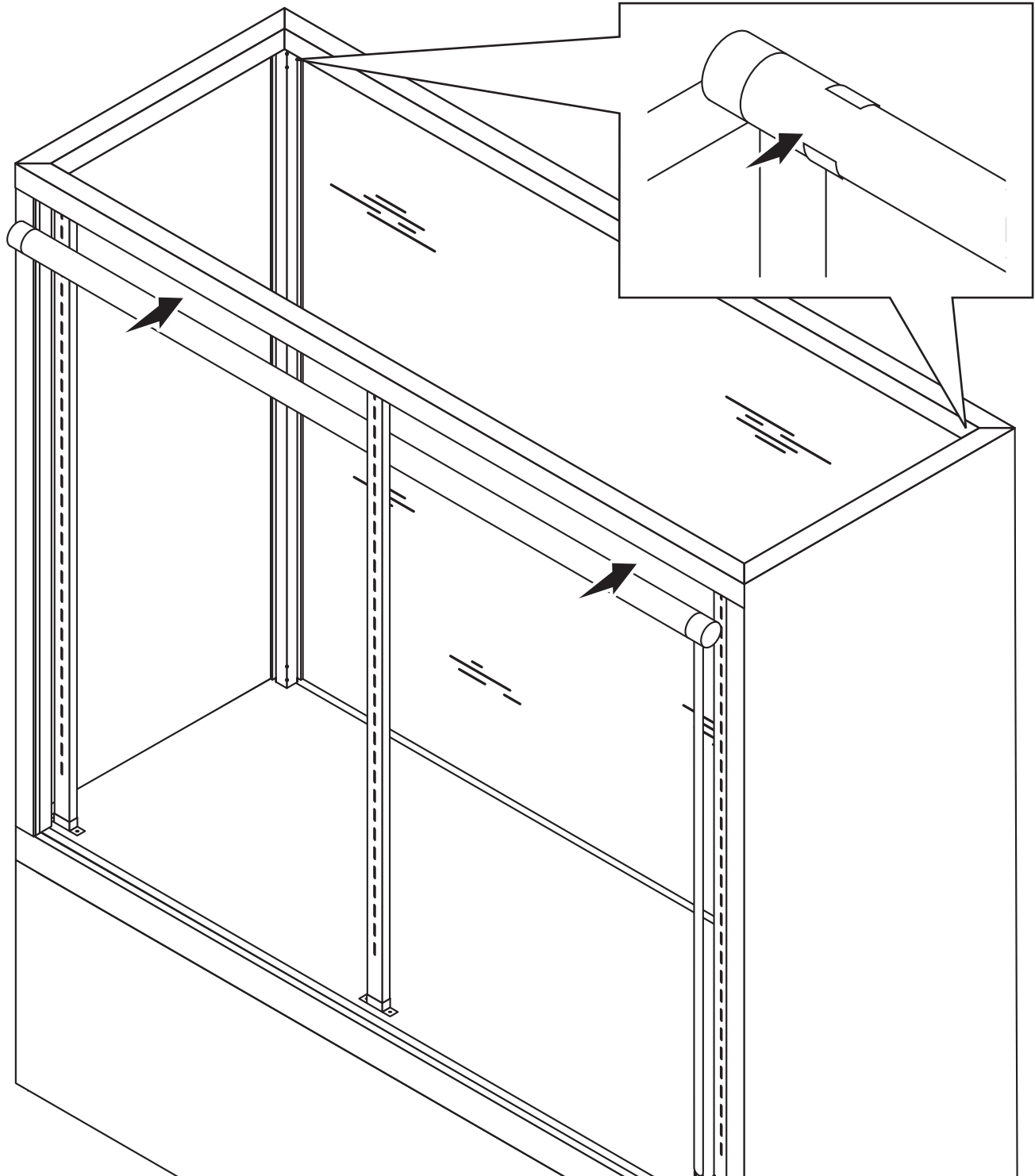

# ASSEMBLY INSTRUCTIONS MANUAL

## 65847 65848 - LED LIGHT KIT FOR 48" & 70" ECONOMY FULL VISION SHOWCASE

### STEP 7

TO COMPLETE THIS INSTALLATION, THE DISPLAY WILL NEED TO BE ACCESSED FROM THE BOTTOM. PLACE THE TRANSFORMER BRACKET OVER THE TRANSFORMER AND SCREW (#2 SCREWS) INTO PLACE WITH THE PRE-DRILLED HOLES . **DO NOT OVER TIGHTEN.**

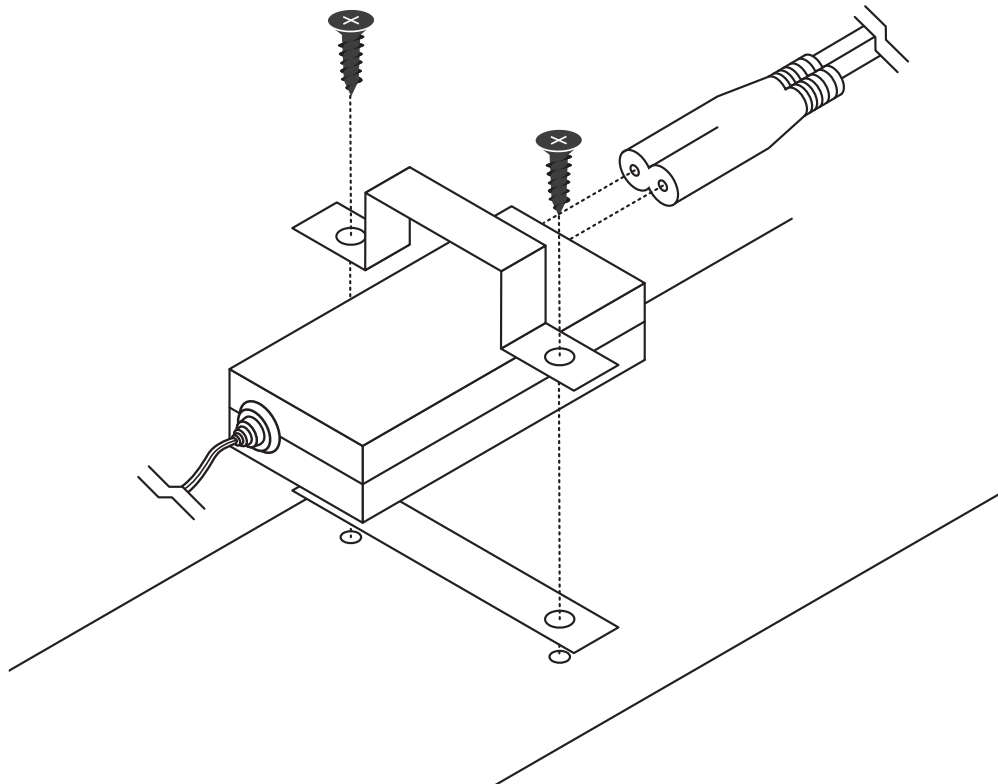

### STEP 8

LASTLY, SLIDE THE BARE WIRES INTO THE WIRE CLIPS, THEN CONNECT. **(NOTE: THE WIRES CAN BE ON EITHER SIDE)** INSTALLATION IS COMPLETE.

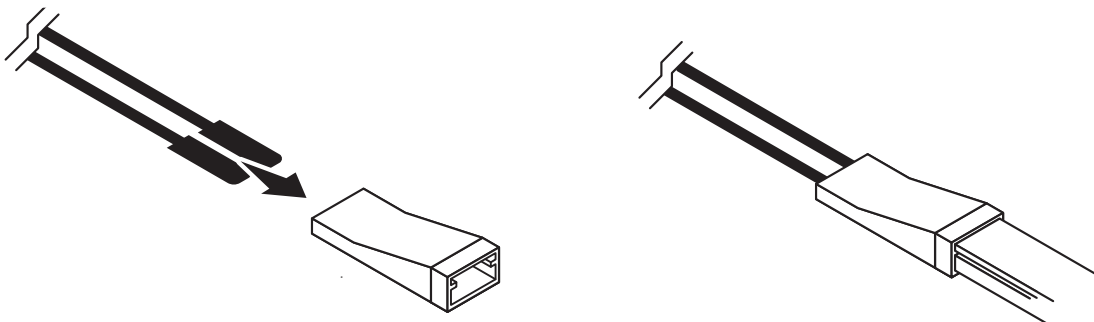

# ASSEMBLY INSTRUCTIONS MANUAL

65847 65848 - LED LIGHT KIT FOR 48" & 70"  
METAL FRAMED FULL VISION SHOWCASE

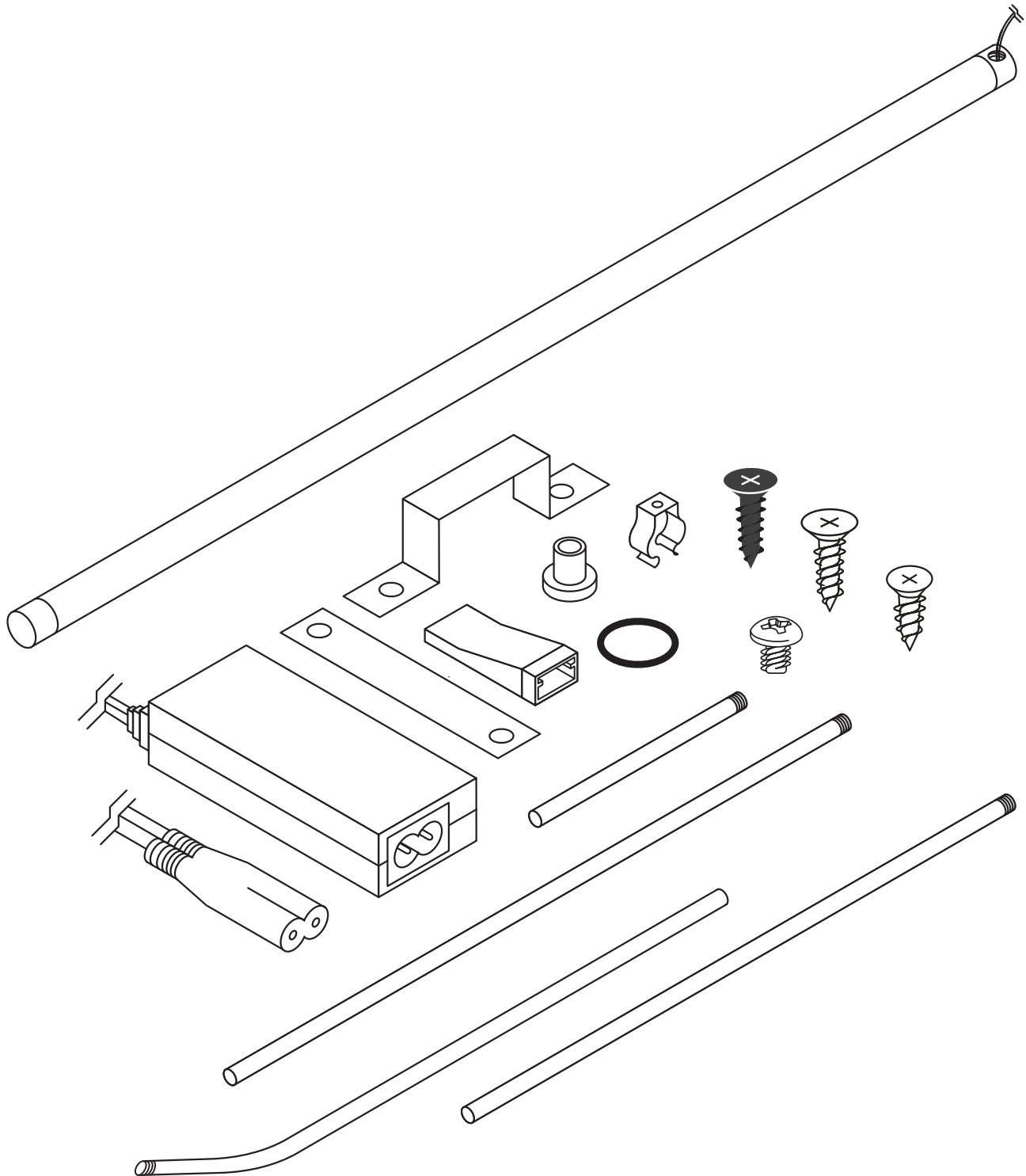

# ASSEMBLY INSTRUCTIONS MANUAL

## 65847 65848 - LED LIGHT KIT FOR 48" & 70" METAL FRAMED FULL VISION SHOWCASE

### PARTS IN CARTON:

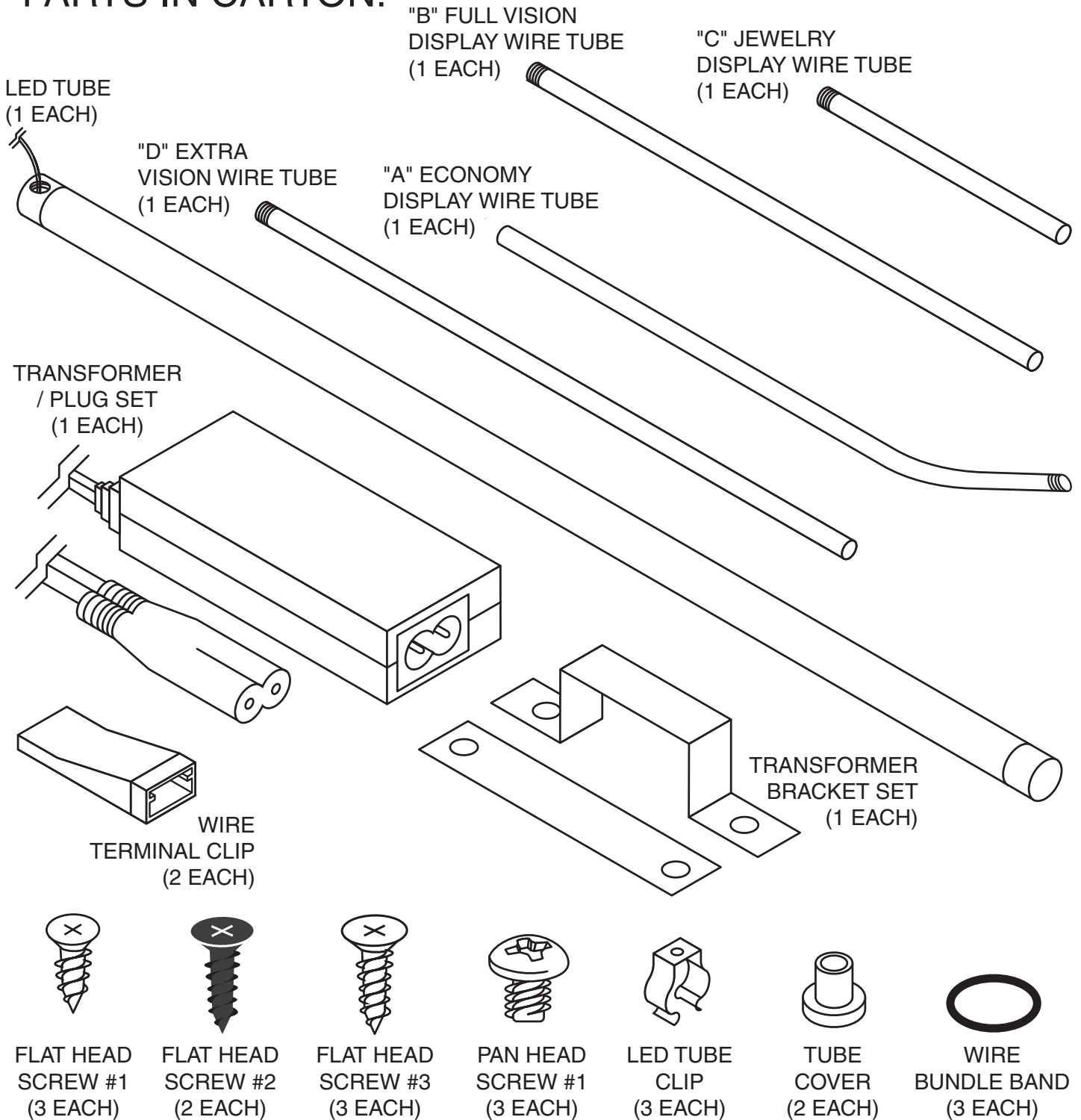

YOU WILL NEED TO SUPPLY YOUR OWN DRILL OR SCREWDRIVER  
FOR INSTALLATION.

# ASSEMBLY INSTRUCTIONS MANUAL

## 65847 65848 - LED LIGHT KIT FOR 48" & 70" METAL FRAMED FULL VISION SHOWCASE

### STEP 1

REMOVE FRONT INNER MOST SCREW FROM THE  
FRAME. REPEAT ON THE OPPOSITE SIDE.

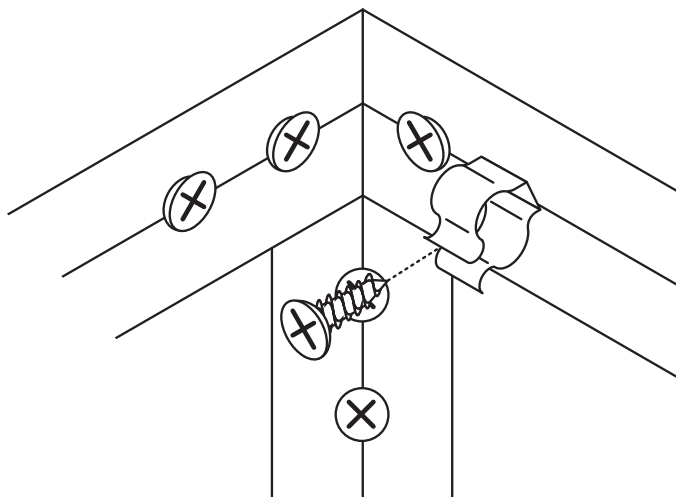
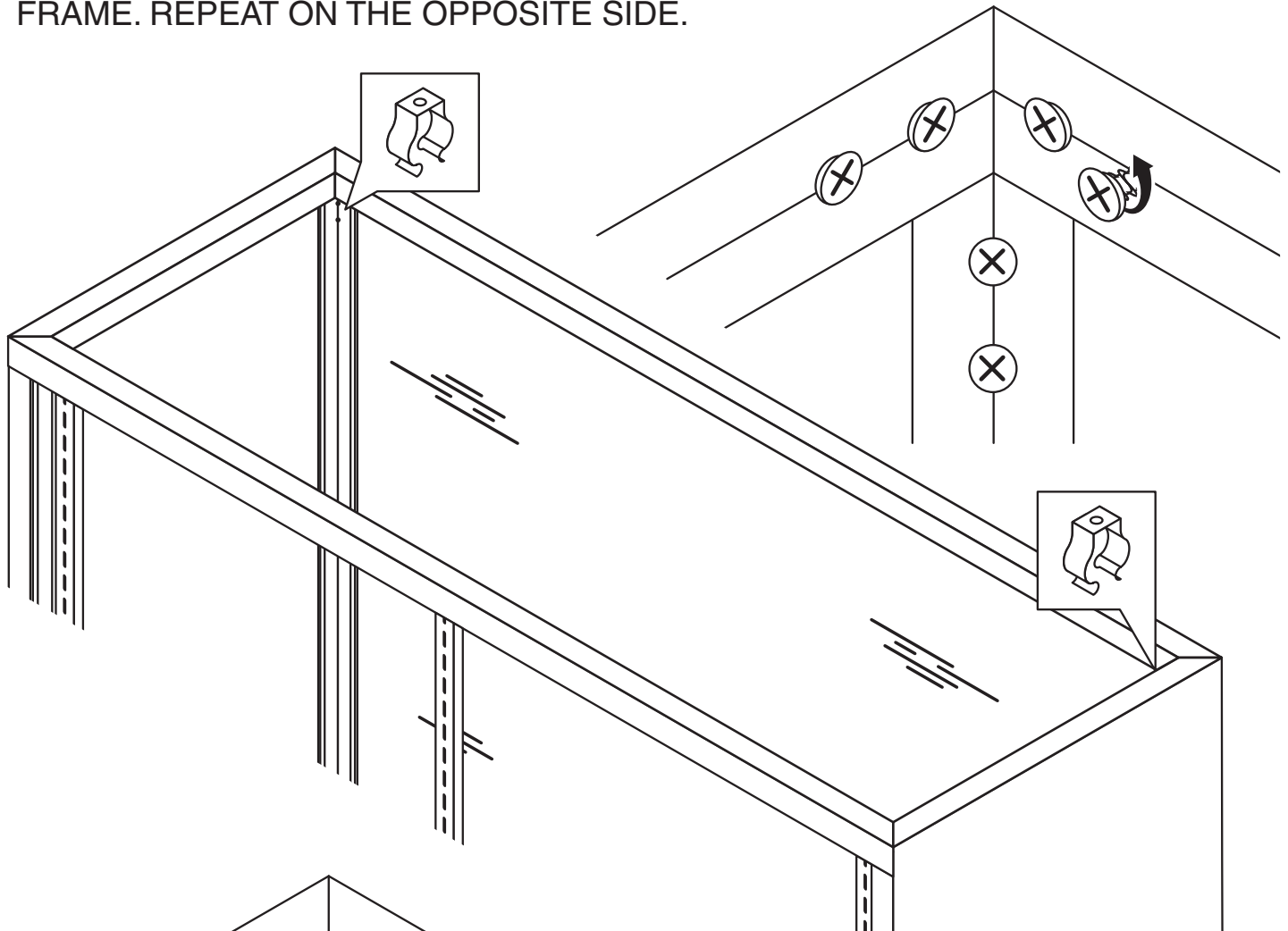

### STEP 2

REPLACE (REMOVED) SCREWS  
WITH NEW FLAT HEAD SCREW #1.  
PLACE TUBE CLIP INTO PLACE AND  
TIGHTEN SCREW. REPEAT  
ON OPPOSITE SIDE

# ASSEMBLY INSTRUCTIONS MANUAL

## 65847 65848 - LED LIGHT KIT FOR 48" & 70" METAL FRAMED FULL VISION SHOWCASE

### STEP 3

TAKE THE WIRES FROM THE LED BAR AND THREAD THEM THROUGH THE "B" FULL VISION WIRE TUBE, **STARTING FROM THE THREADED END OF THE TUBE.**

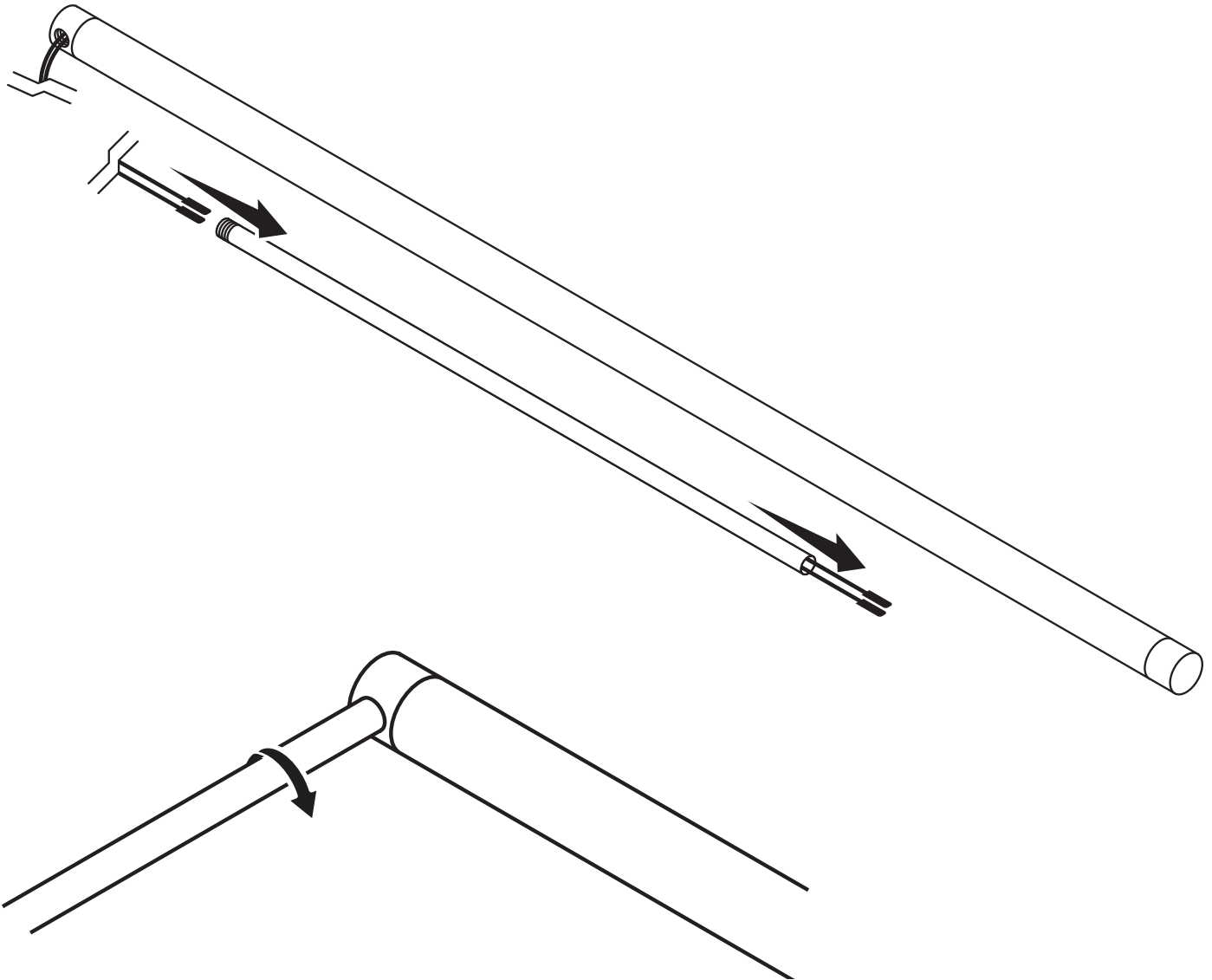

### STEP 4

NEXT, SCREW IN THREADED END OF THE "B" TUBE INTO THE LED TUBE.

# ASSEMBLY INSTRUCTIONS MANUAL

## 65847 65848 - LED LIGHT KIT FOR 48" & 70" METAL FRAMED FULL VISION SHOWCASE

### STEP 5

PLACE THE TUBE COVER INTO THE PRE-DRILLED HOLE, LOCATED IN THE FRONT CORNER OF THE DISPLAY.

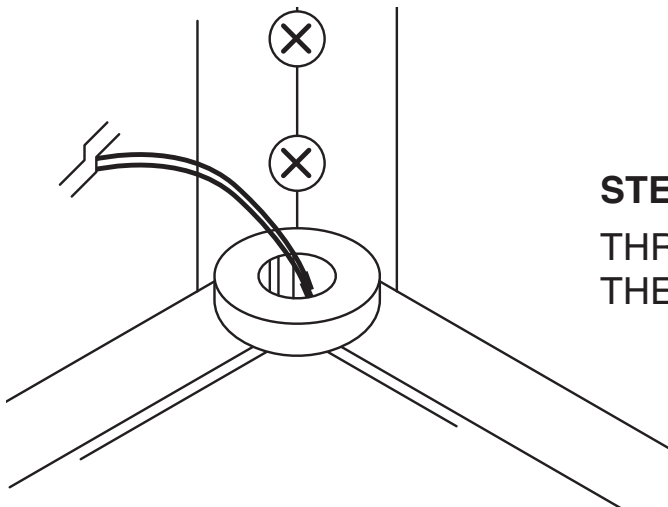
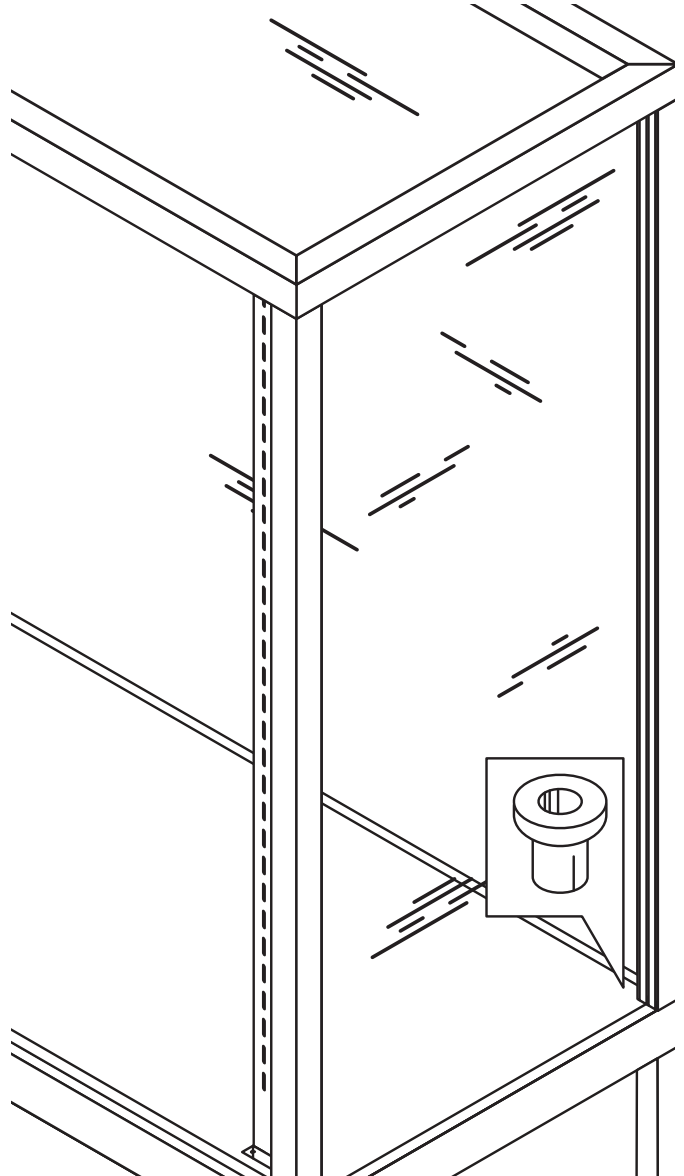
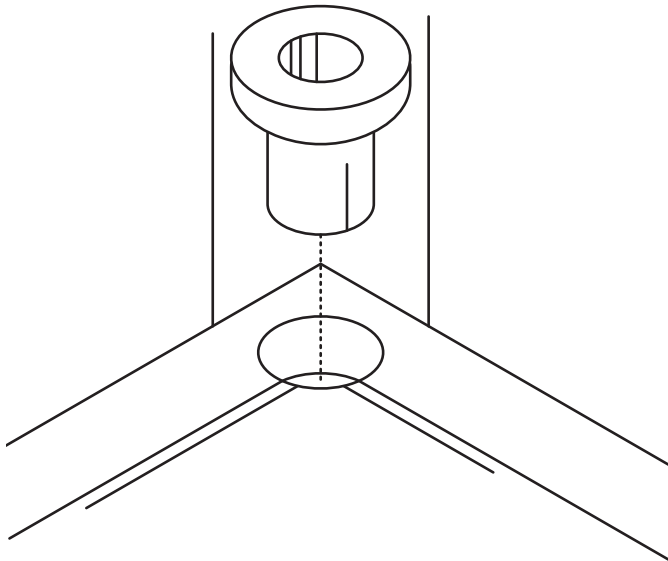

### STEP 6

THREAD THE EXCESS LED WIRE THROUGH THE TUBE COVER.

# ASSEMBLY INSTRUCTIONS MANUAL

## 65847 65848 - LED LIGHT KIT FOR 48" & 70" METAL FRAMED FULL VISION SHOWCASE

### STEP 7

CAREFULLY SLIDE IN THE LED TUBE ASSEMBLY INTO THE DISPLAY. ALIGN WIRE TUBE WITH TUBE COVER, SLIDE IN AND CLIP LED TUBE INTO PLACE.

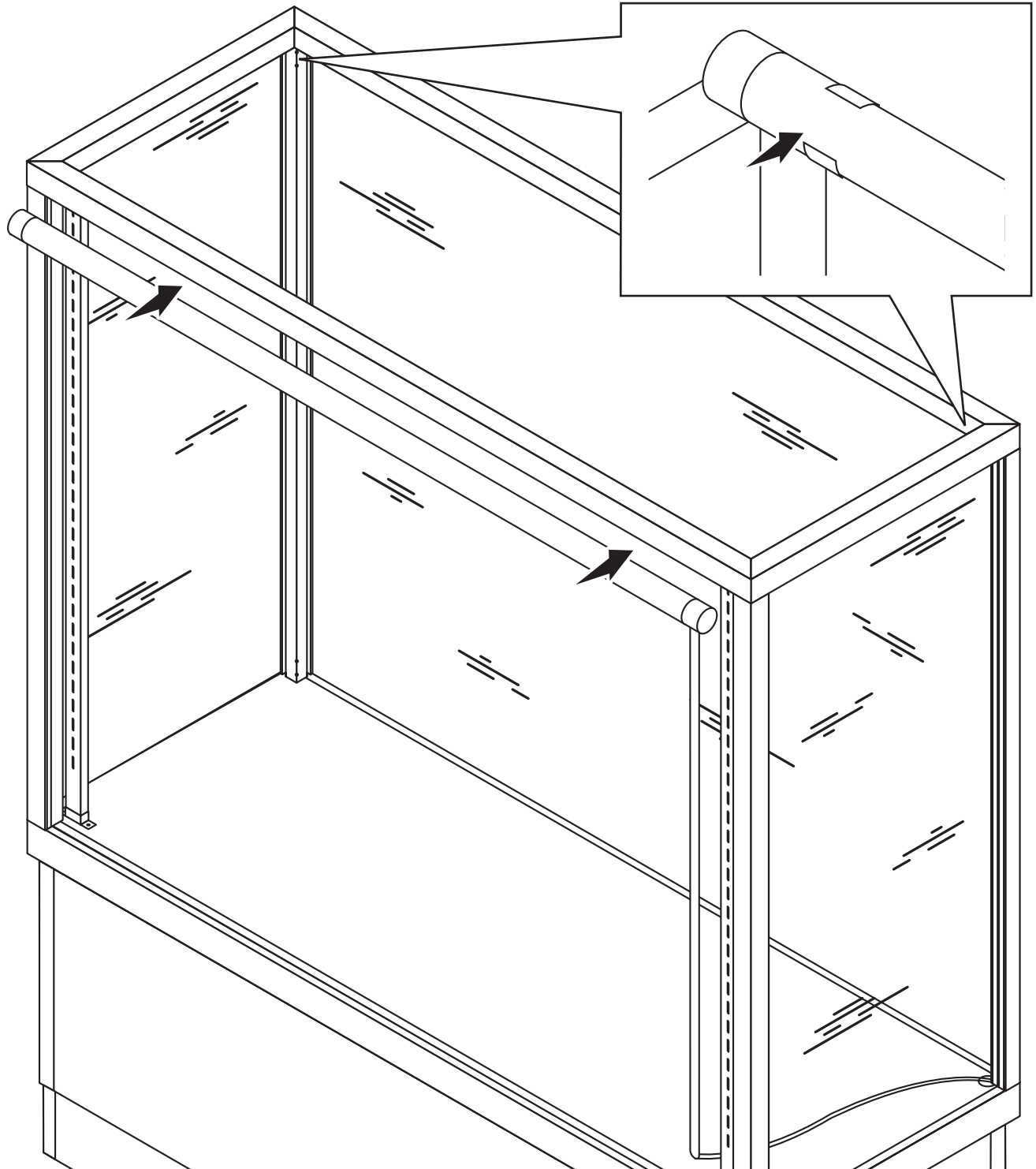

# ASSEMBLY INSTRUCTIONS MANUAL

## 65847 65848 - LED LIGHT KIT FOR 48" & 70" METAL FRAMED FULL VISION SHOWCASE

### STEP 8

TO COMPLETE THIS INSTALLATION, THE DISPLAY WILL NEED TO BE ACCESSED FROM THE BOTTOM. PLACE THE TRANSFORMER BRACKET OVER THE TRANSFORMER AND SCREW (#2 SCREWS) INTO PLACE WITH THE PRE-DRILLED HOLES . **DO NOT OVER TIGHTEN.**

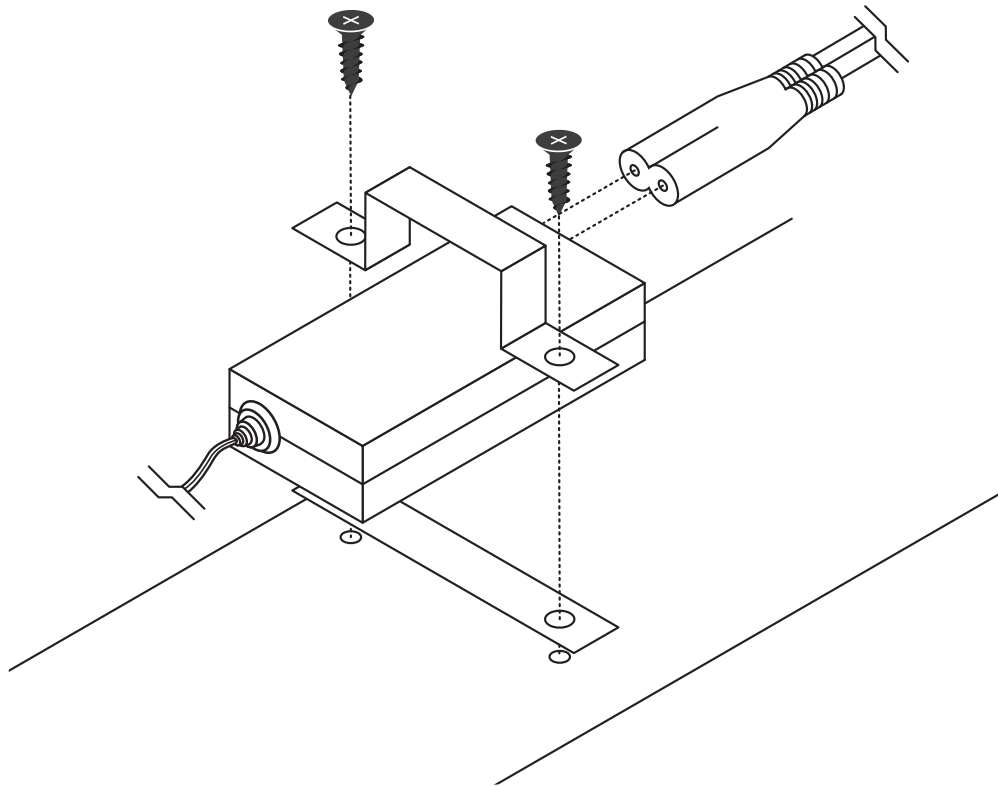

### STEP 9

LASTLY, SLIDE THE BARE WIRES INTO THE WIRE CLIPS, THEN CONNECT. (**NOTE: THE WIRES CAN BE ON EITHER SIDE**) INSTALLATION IS COMPLETE.

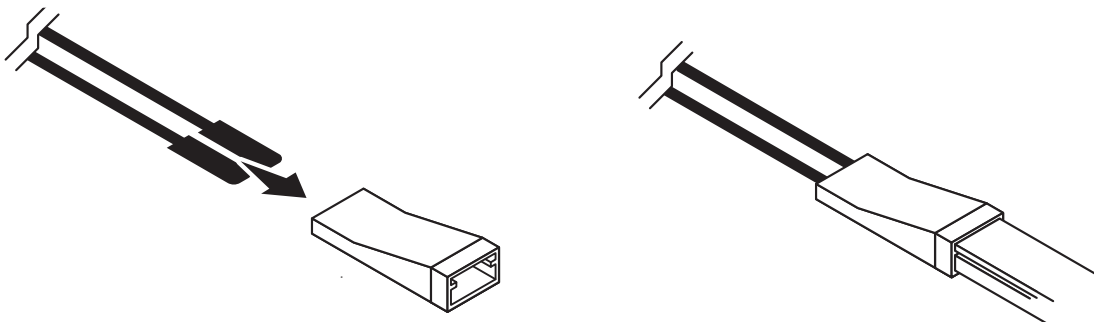

# ASSEMBLY INSTRUCTIONS MANUAL

65847 65848 - LED LIGHT KIT FOR 48" & 70"  
METAL FRAMED EXTRA VISION SHOWCASE

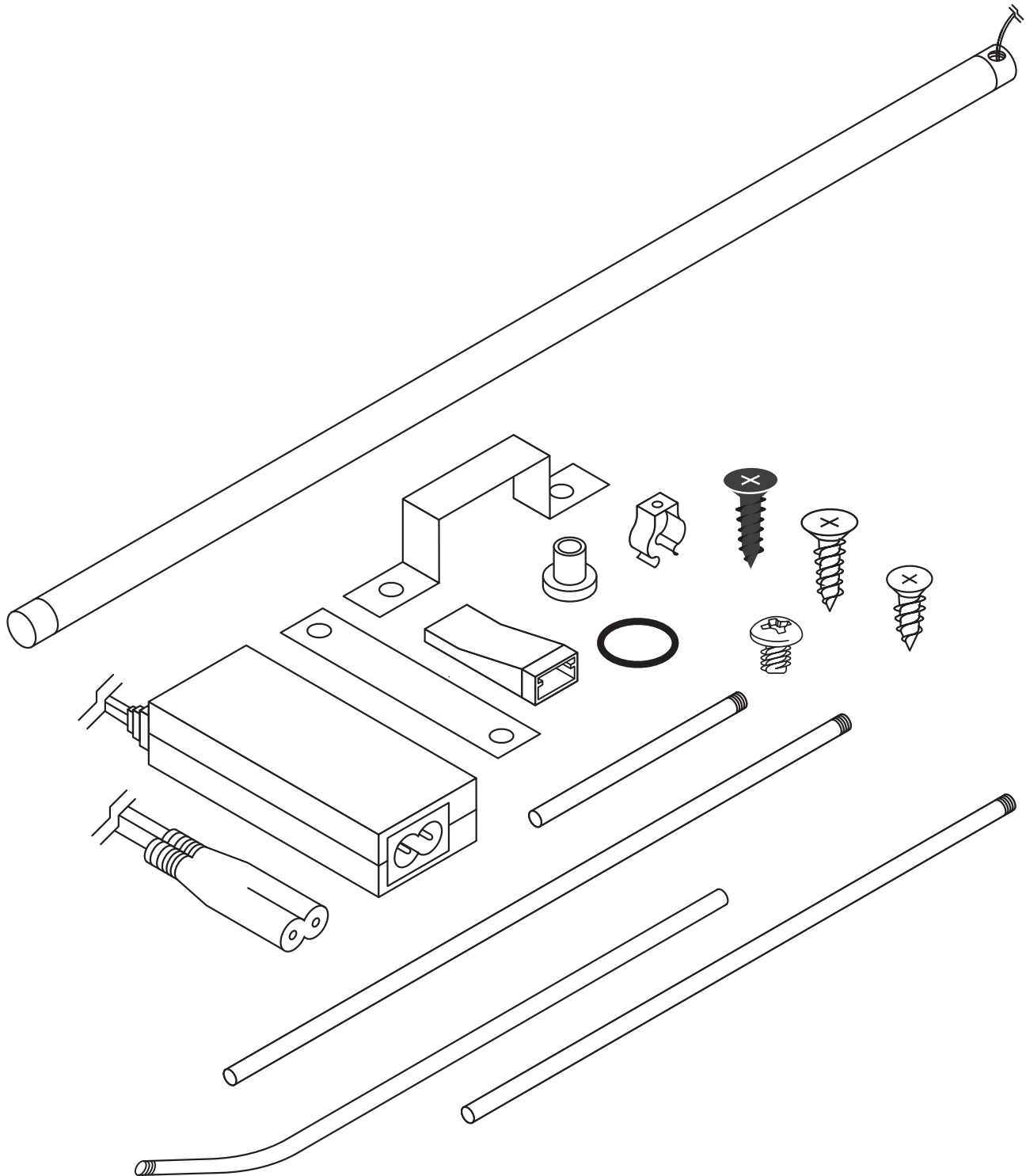

# ASSEMBLY INSTRUCTIONS MANUAL

## 65847 65848 - LED LIGHT KIT FOR 48" & 70" METAL FRAMED EXTRA VISION SHOWCASE

### PARTS IN CARTON:

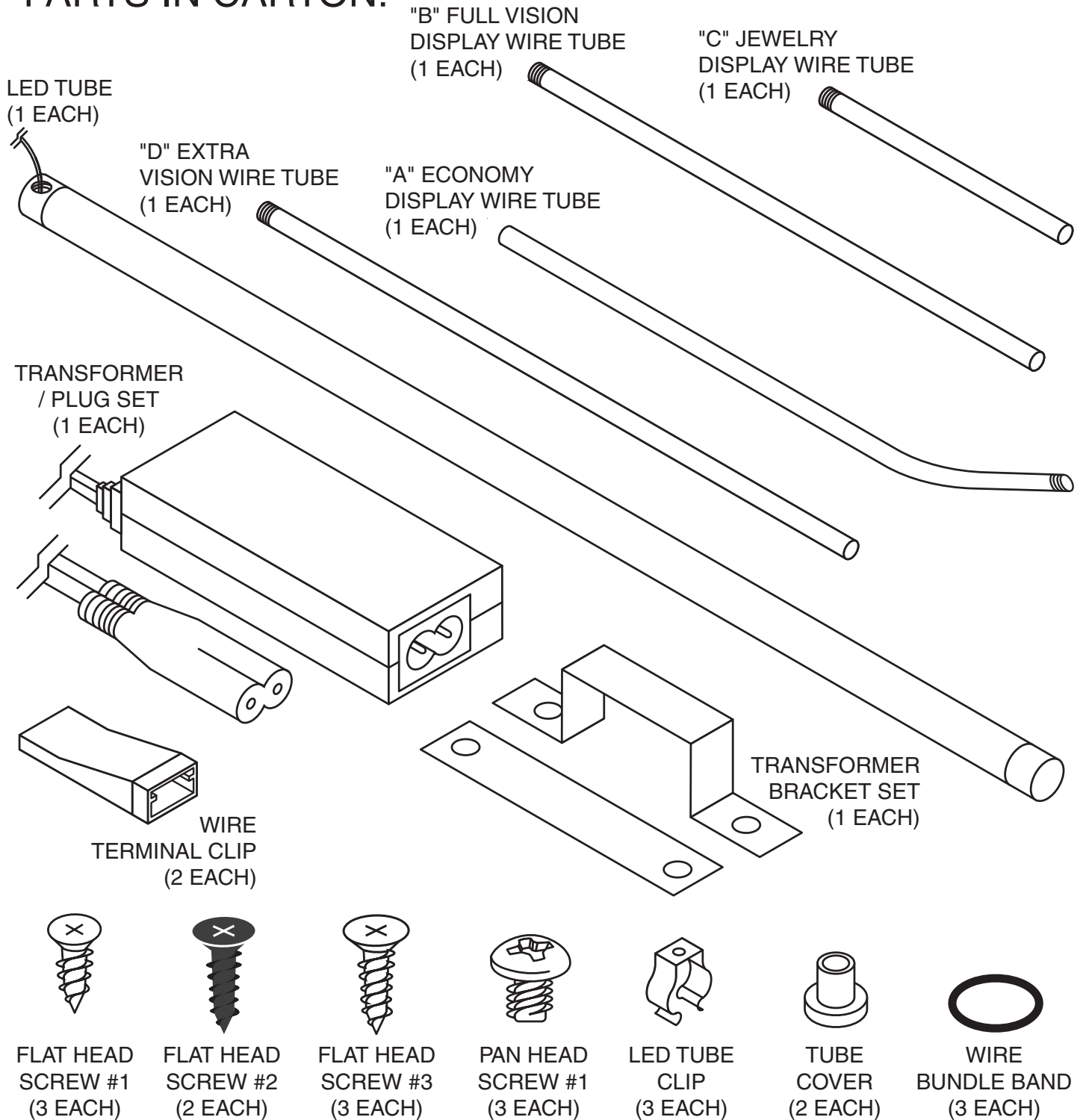

YOU WILL NEED TO SUPPLY YOUR OWN DRILL OR SCREWDRIVER  
FOR INSTALLATION.

# ASSEMBLY INSTRUCTIONS MANUAL

## 65847 65848 - LED LIGHT KIT FOR 48" & 70" METAL FRAMED EXTRA VISION SHOWCASE

### STEP 1

REMOVE FRONT INNER MOST SCREW FROM THE  
FRAME. REPEAT ON THE OPPOSITE SIDE.

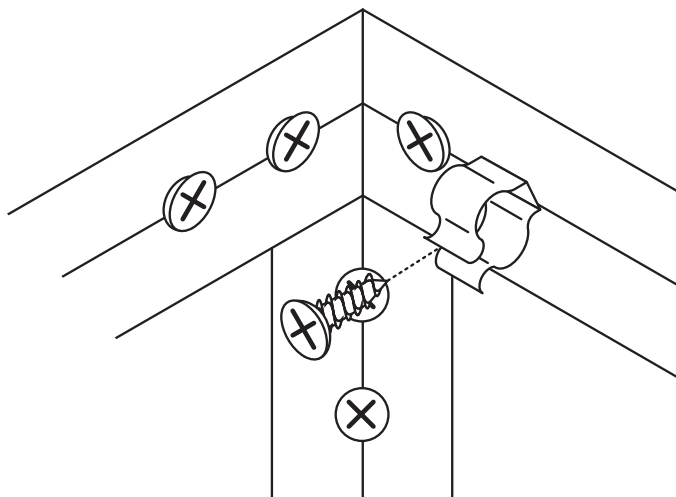
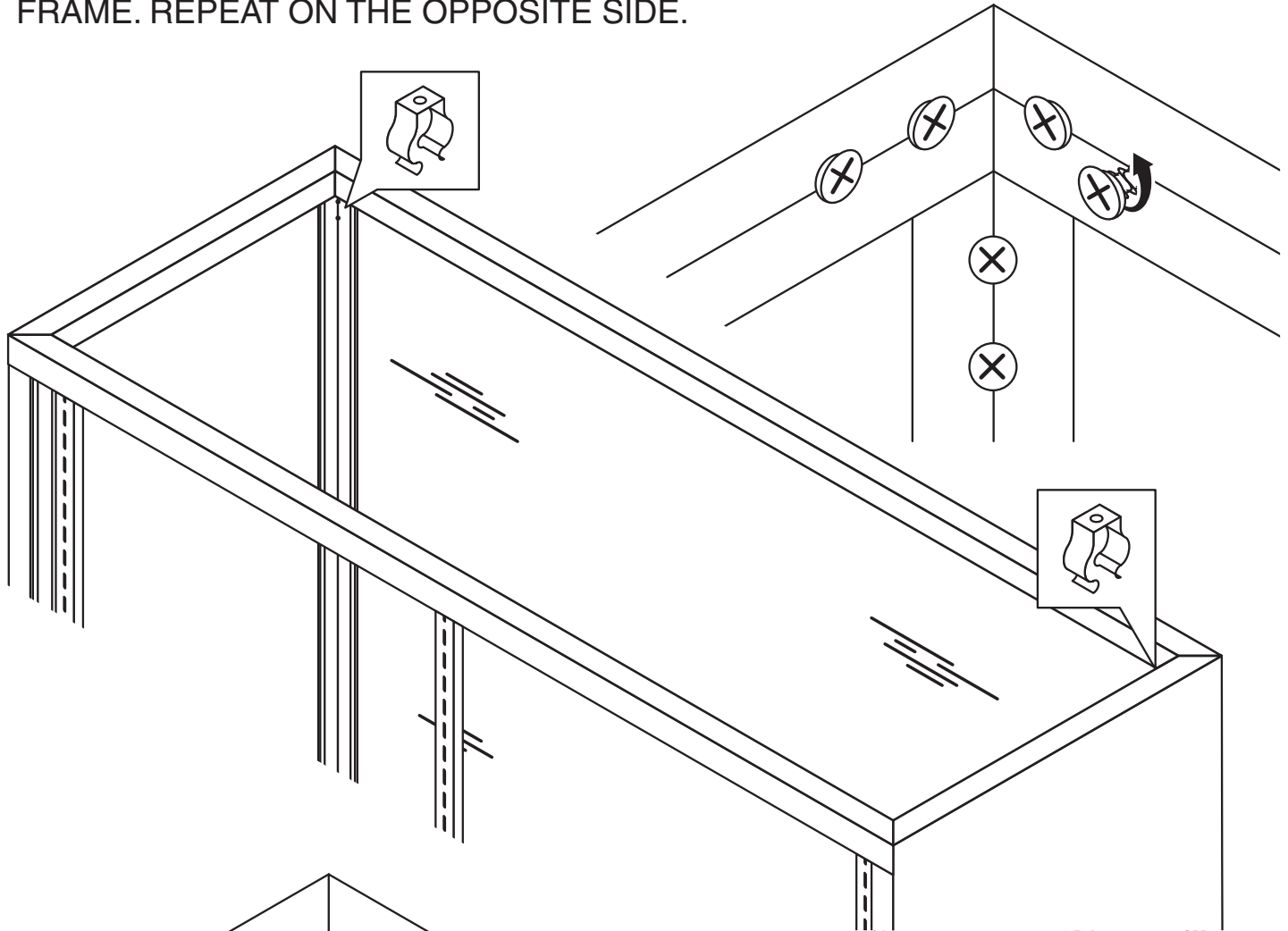

### STEP 2

REPLACE (REMOVED) SCREWS  
WITH NEW FLAT HEAD SCREW #1.  
PLACE TUBE CLIP INTO PLACE AND  
TIGHTEN SCREW. REPEAT  
ON OPPOSITE SIDE

# ASSEMBLY INSTRUCTIONS MANUAL

## 65847 65848 - LED LIGHT KIT FOR 48" & 70" METAL FRAMED EXTRA VISION SHOWCASE

### STEP 3

TAKE THE WIRES FROM THE LED BAR AND THREAD THEM THROUGH THE "D" EXTRA VISION WIRE TUBE, **STARTING FROM THE THREADED END OF THE TUBE.**

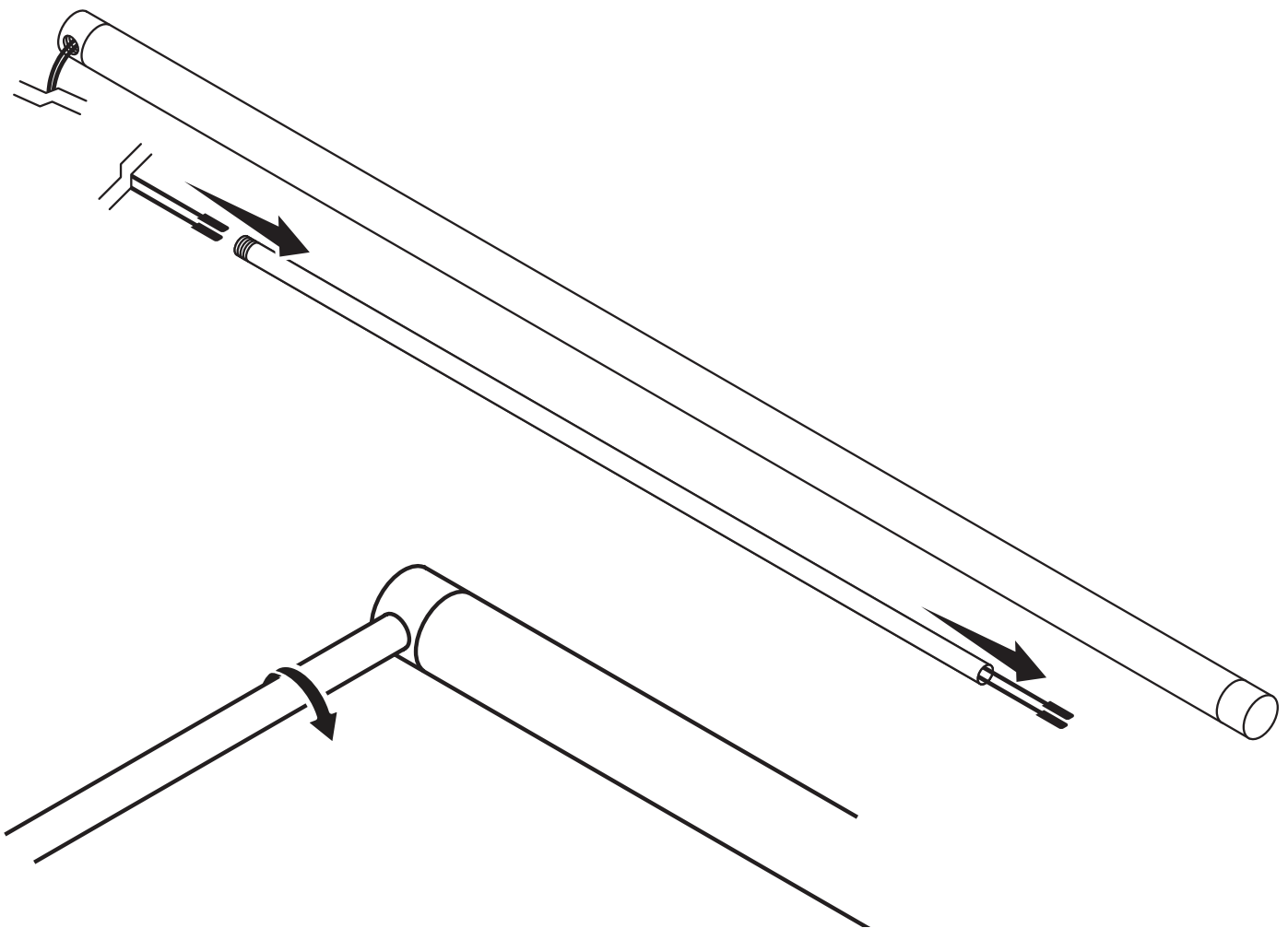

### STEP 4

NEXT, SCREW IN THREADED END OF THE "D" TUBE INTO THE LED TUBE.

# ASSEMBLY INSTRUCTIONS MANUAL

## 65847 65848 - LED LIGHT KIT FOR 48" & 70" METAL FRAMED EXTRA VISION SHOWCASE

### STEP 5

PLACE THE TUBE COVER INTO  
THE PRE-DRILLED HOLE, LOCATED  
IN THE FRONT CORNER OF THE  
DISPLAY.

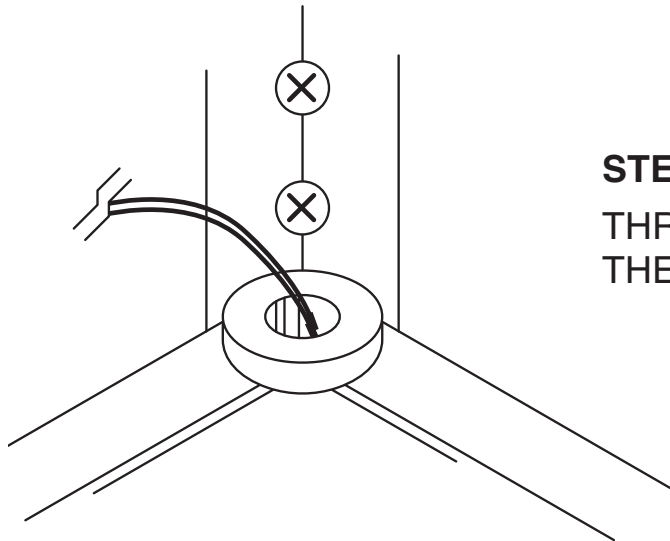
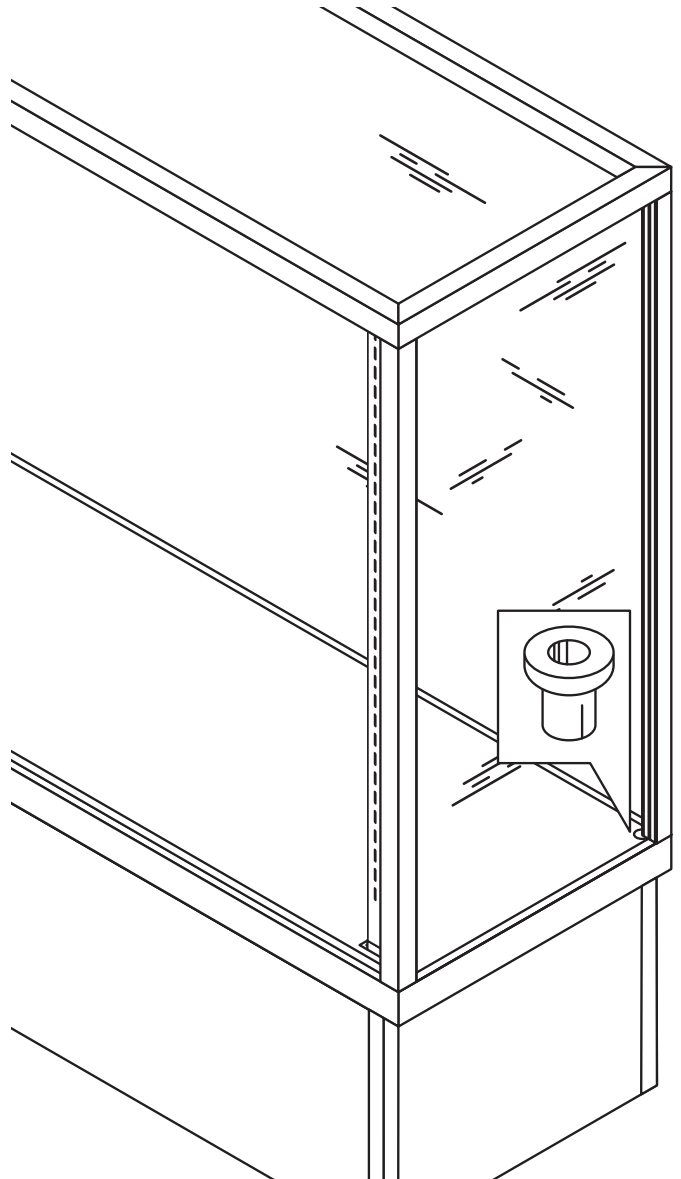
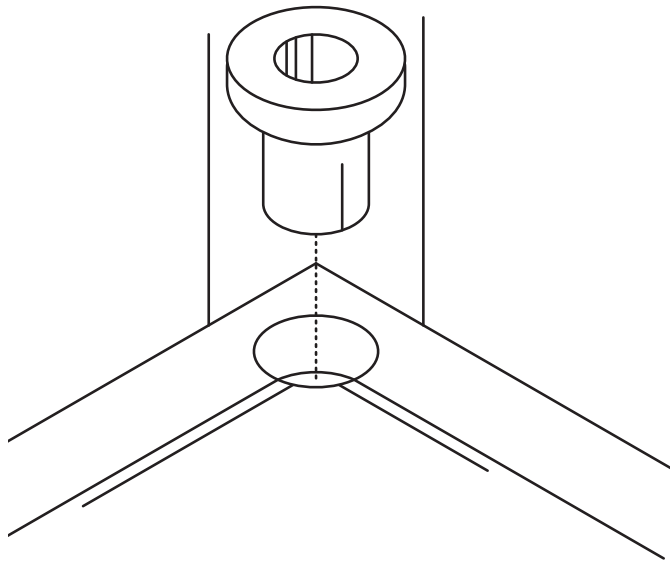

### STEP 6

THREAD THE EXCESS LED WIRE THROUGH  
THE TUBE COVER.

# ASSEMBLY INSTRUCTIONS MANUAL

## 65847 65848 - LED LIGHT KIT FOR 48" & 70" METAL FRAMED EXTRA VISION SHOWCASE

### STEP 7

CAREFULLY SLIDE IN THE LED TUBE ASSEMBLY INTO THE DISPLAY. ALIGN WIRE TUBE WITH TUBE COVER, SLIDE IN AND CLIP LED TUBE INTO PLACE.

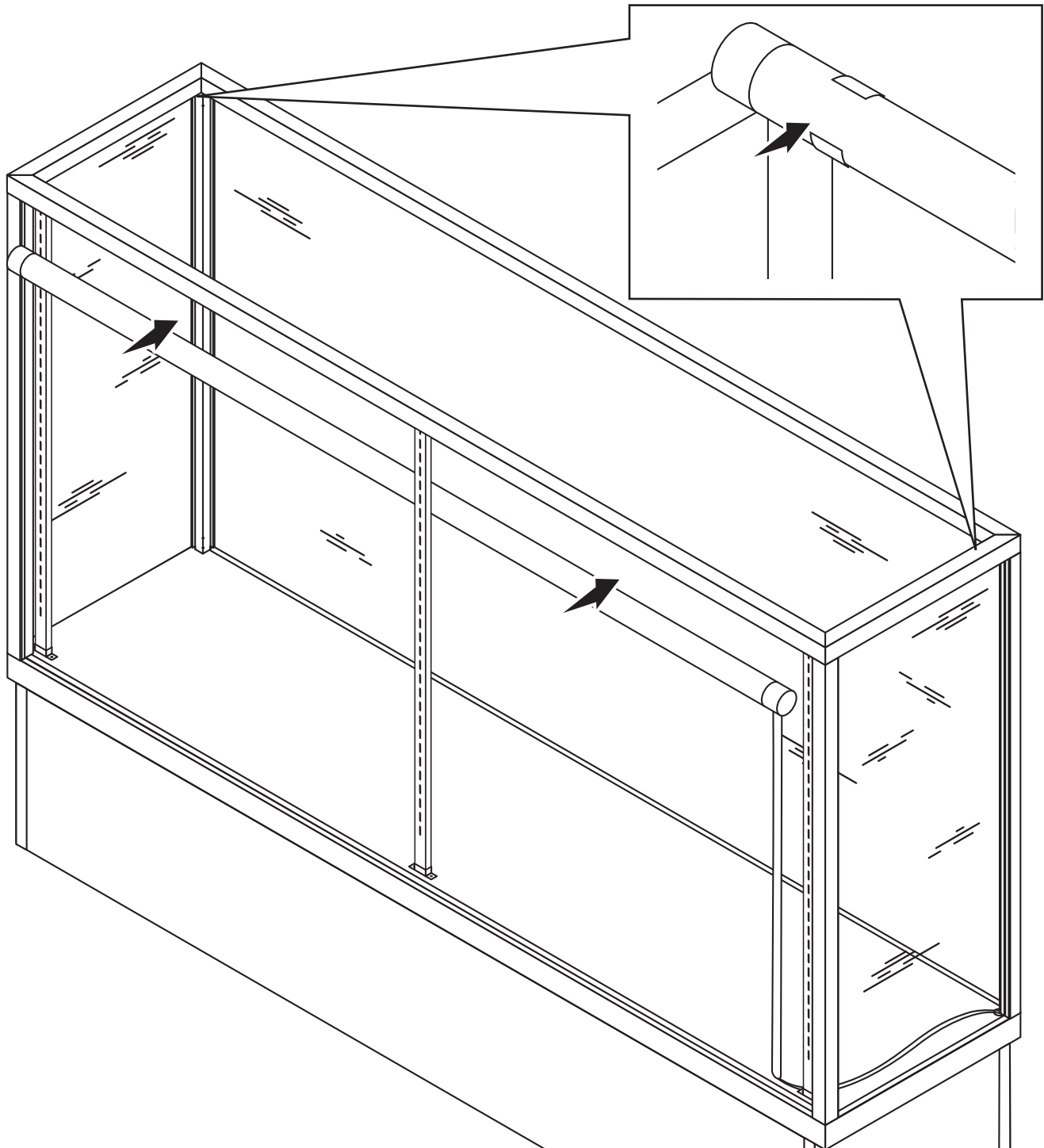

# ASSEMBLY INSTRUCTIONS MANUAL

## 65847 65848 - LED LIGHT KIT FOR 48" & 70" METAL FRAMED EXTRA VISION SHOWCASE

### STEP 8

TO COMPLETE THIS INSTALLATION, THE DISPLAY WILL NEED TO BE ACCESSED FROM THE BOTTOM. PLACE THE TRANSFORMER BRACKET OVER THE TRANSFORMER AND SCREW (#2 SCREWS) INTO PLACE WITH THE PRE-DRILLED HOLES . **DO NOT OVER TIGHTEN.**

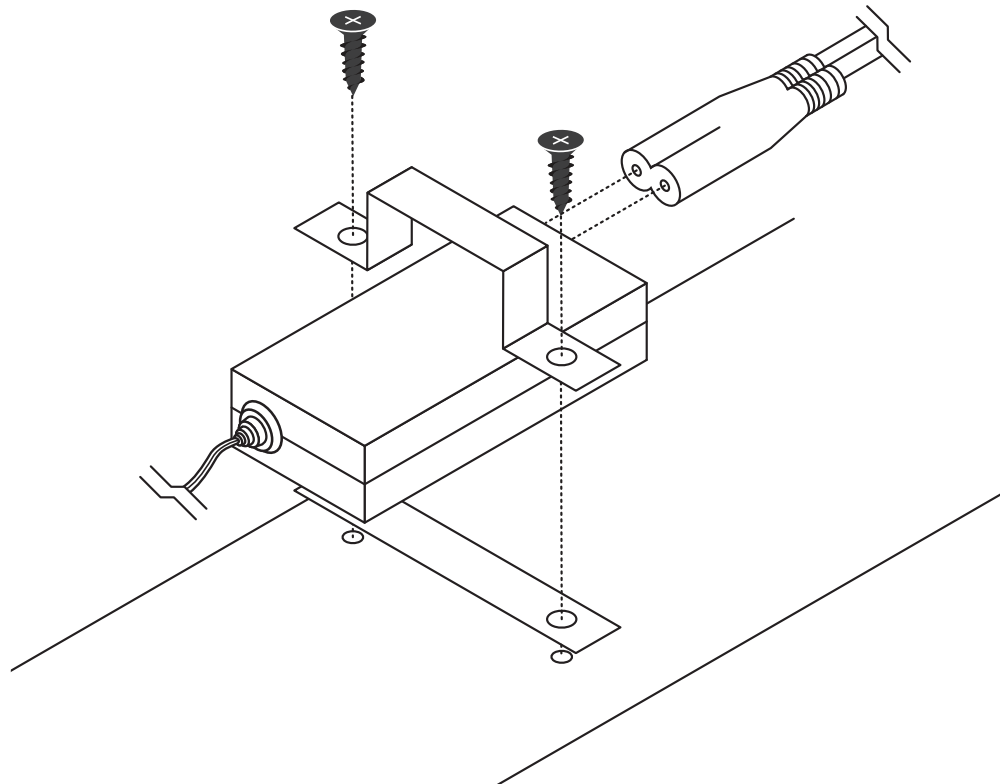

### STEP 9

LASTLY, SLIDE THE BARE WIRES INTO THE WIRE CLIPS, THEN CONNECT. **(NOTE: THE WIRES CAN BE ON EITHER SIDE)** INSTALLATION IS COMPLETE.

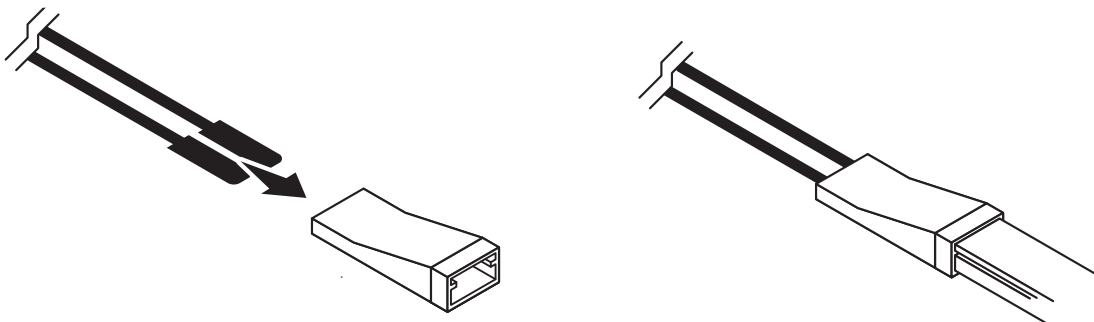

# ASSEMBLY INSTRUCTIONS MANUAL

65847 65848 - LED LIGHT KIT FOR 48" & 70"  
METAL FRAMED JEWELRY SHOWCASE

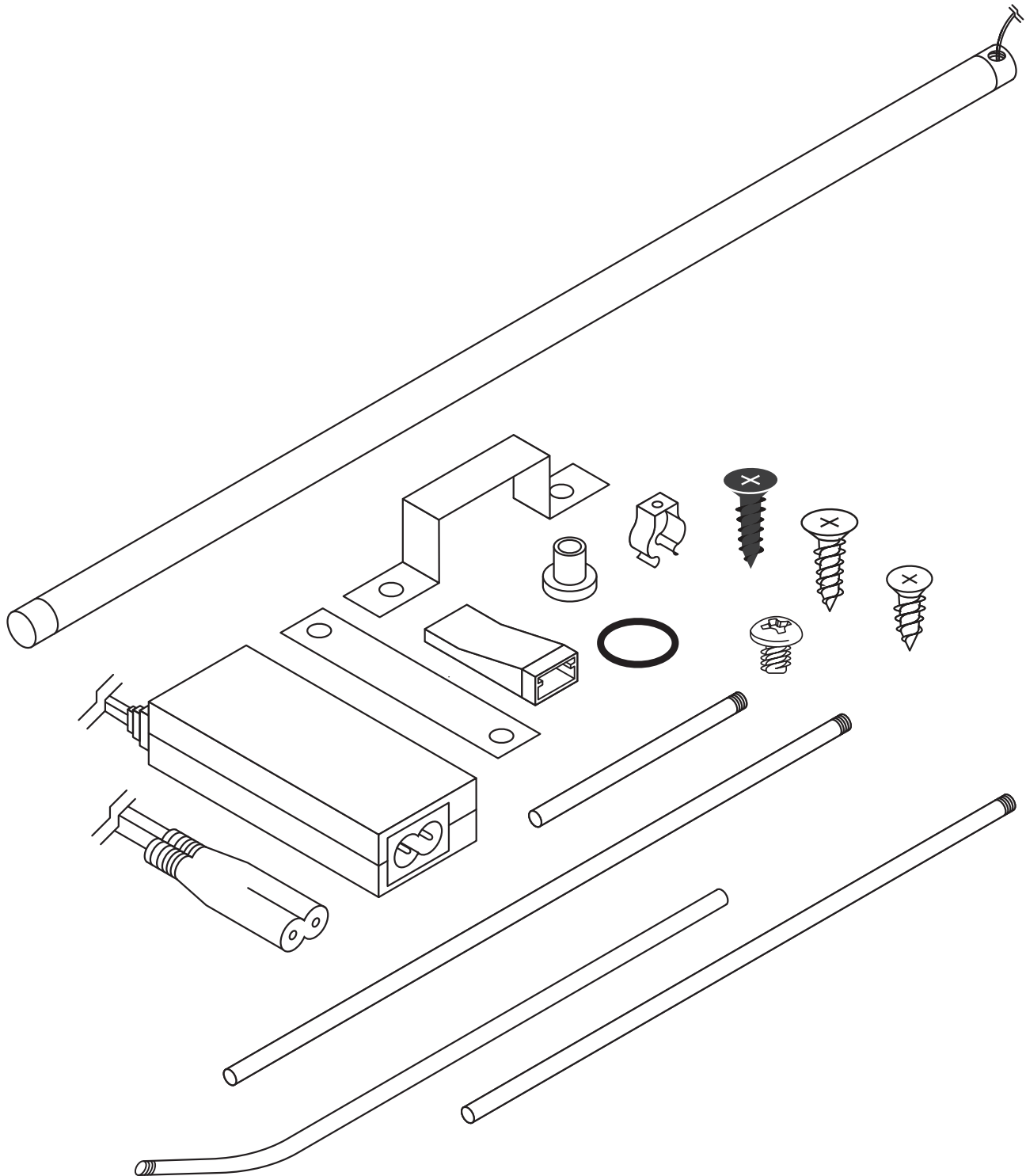

# ASSEMBLY INSTRUCTIONS MANUAL

## 65847 65848 - LED LIGHT KIT FOR 48" & 70" METAL FRAMED JEWELRY SHOWCASE

### PARTS IN CARTON:

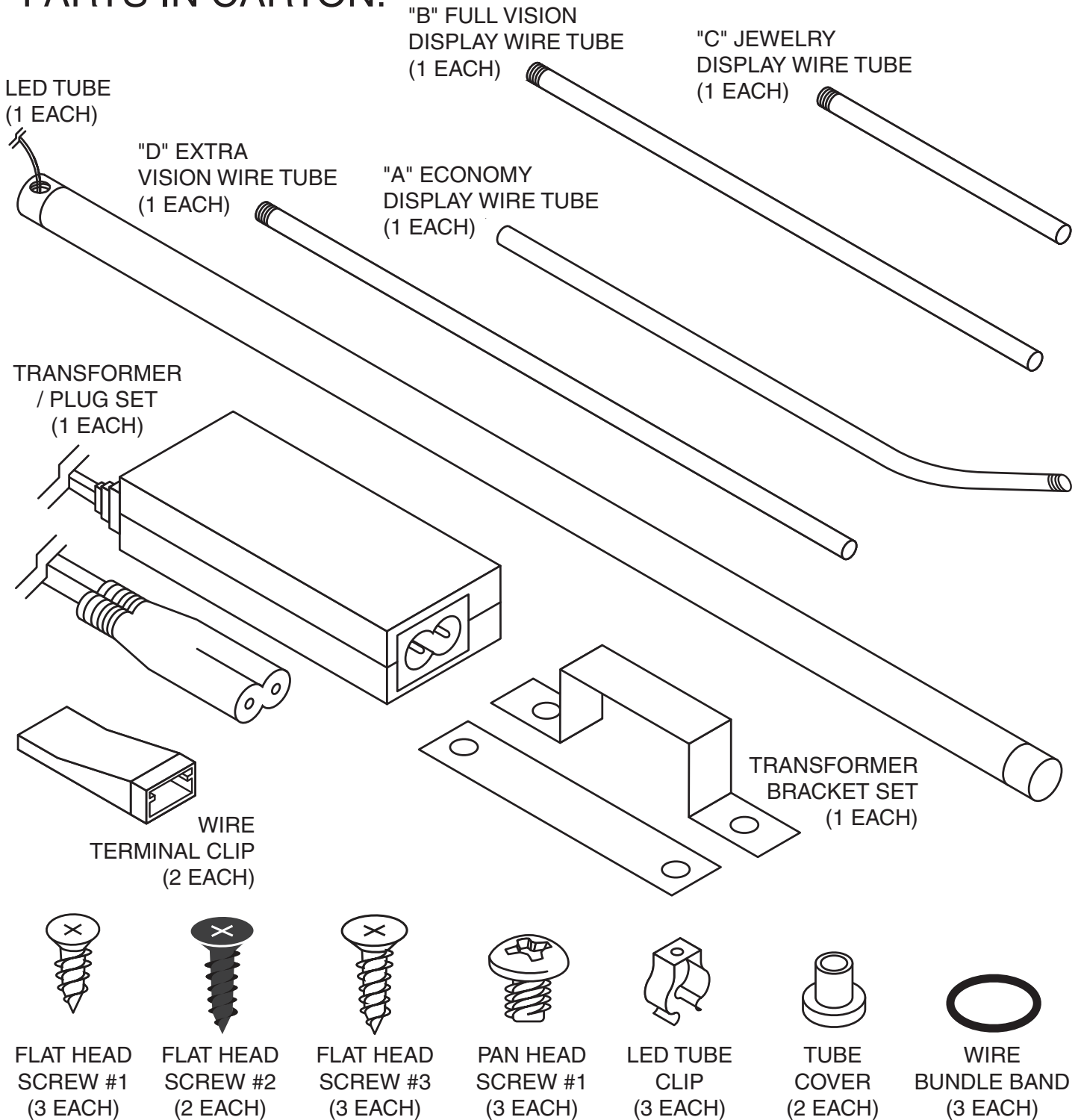

YOU WILL NEED TO SUPPLY YOUR OWN DRILL OR SCREWDRIVER  
FOR INSTALLATION.

# ASSEMBLY INSTRUCTIONS MANUAL

## 65847 65848 - LED LIGHT KIT FOR 48" & 70" METAL FRAMED JEWELRY SHOWCASE

### STEP 1

PLACE TUBE CLIP INTO PLACE, APPROX. 2IN FROM CORNER, AND TIGHTEN SCREW. REPEAT IN THE MIDDLE, AND ON OPPOSITE CORNER.

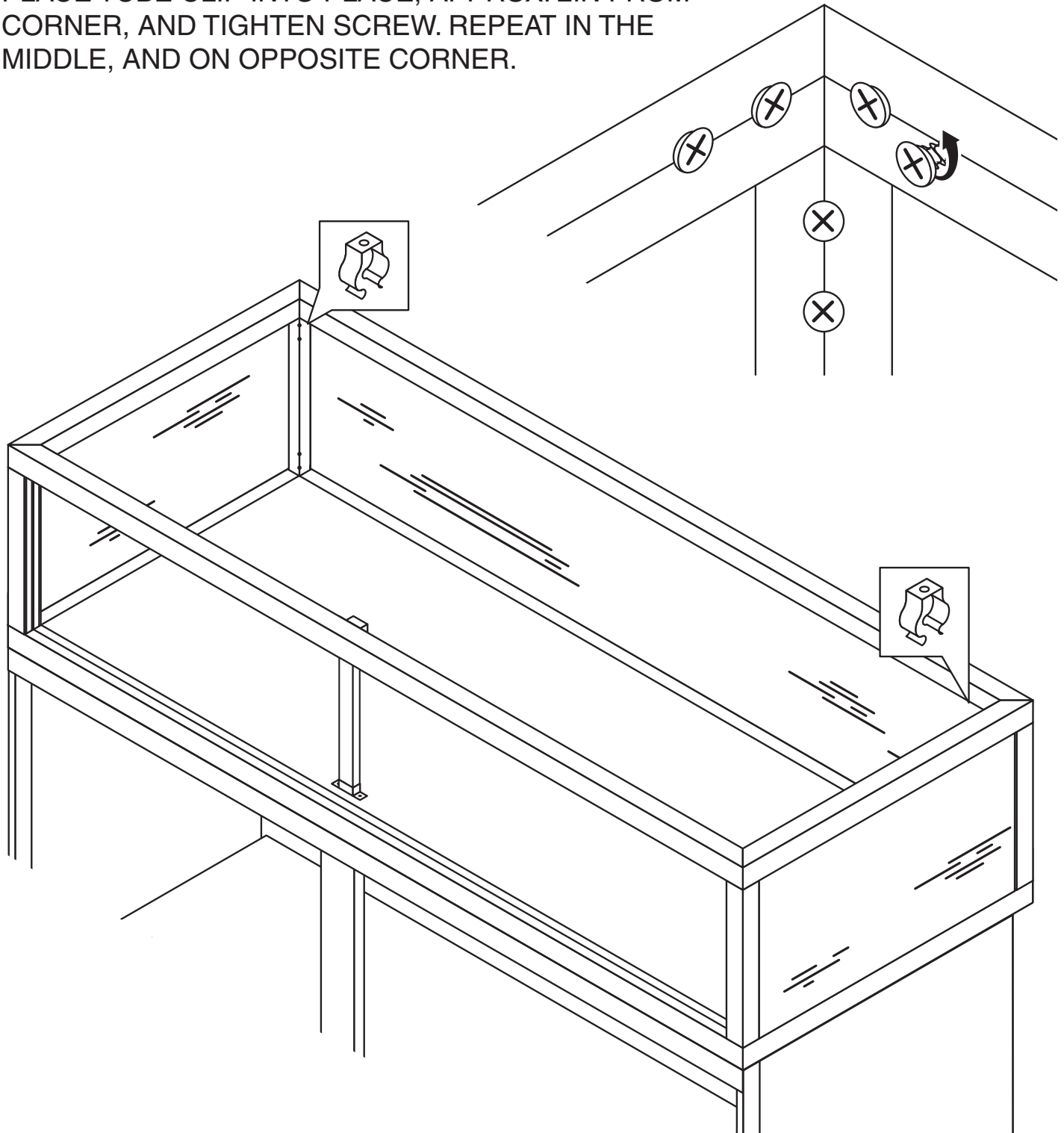

# ASSEMBLY INSTRUCTIONS MANUAL

## 65847 65848 - LED LIGHT KIT FOR 48" & 70" METAL FRAMED JEWELRY SHOWCASE

### STEP 2

TAKE THE WIRES FROM THE LED BAR AND THREAD THEM THROUGH THE "C" EXTRA VISION WIRE TUBE, **STARTING FROM THE THREADED END OF THE TUBE.**

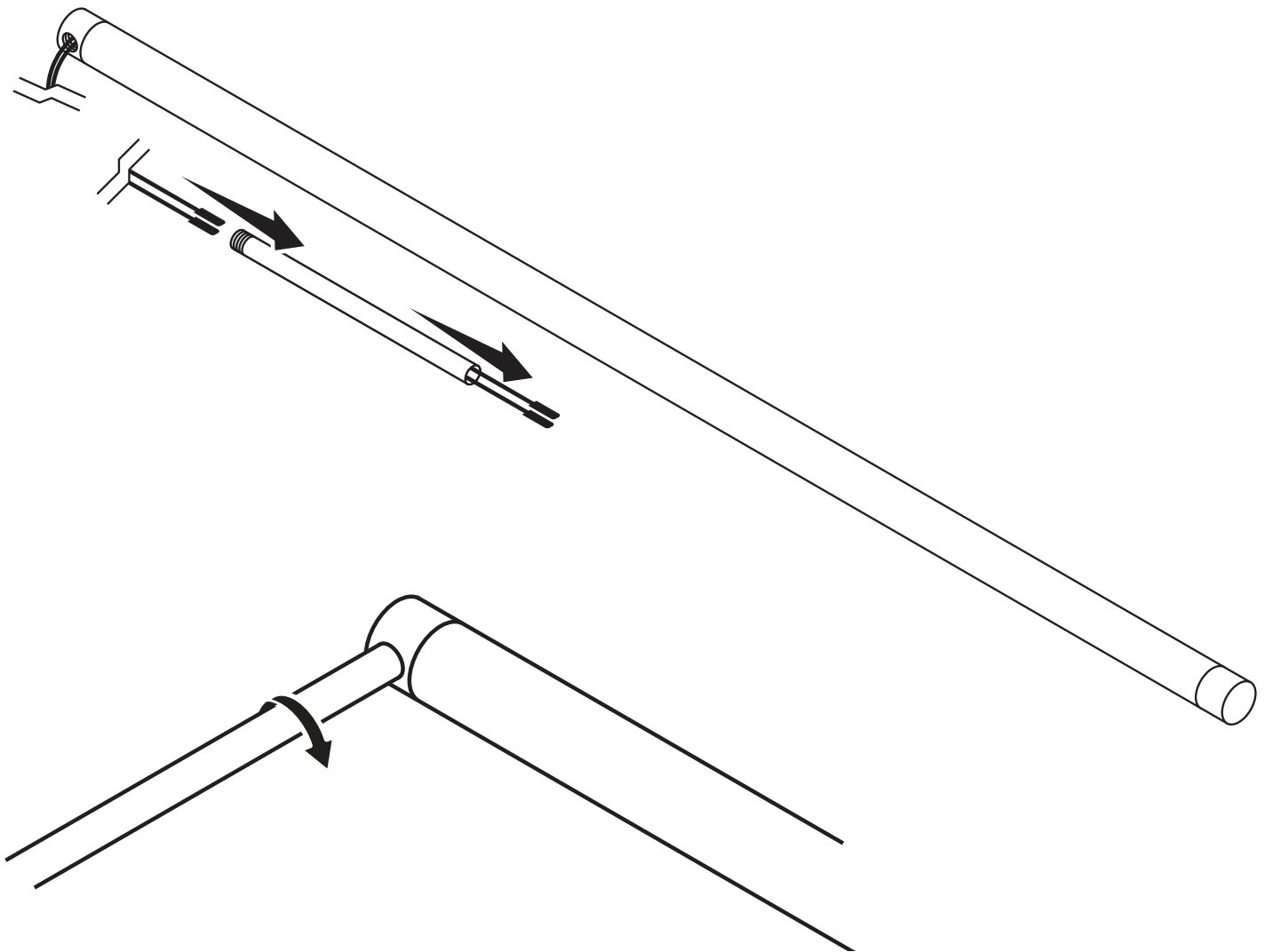

### STEP 3

NEXT, SCREW IN THREADED END OF THE "C" TUBE INTO THE LED TUBE.

# ASSEMBLY INSTRUCTIONS MANUAL

## 65847 65848 - LED LIGHT KIT FOR 48" & 70" METAL FRAMED JEWELRY SHOWCASE

### STEP 4

PLACE THE TUBE COVER INTO THE PRE-DRILLED HOLE, LOCATED IN THE FRONT CORNER OF THE DISPLAY.

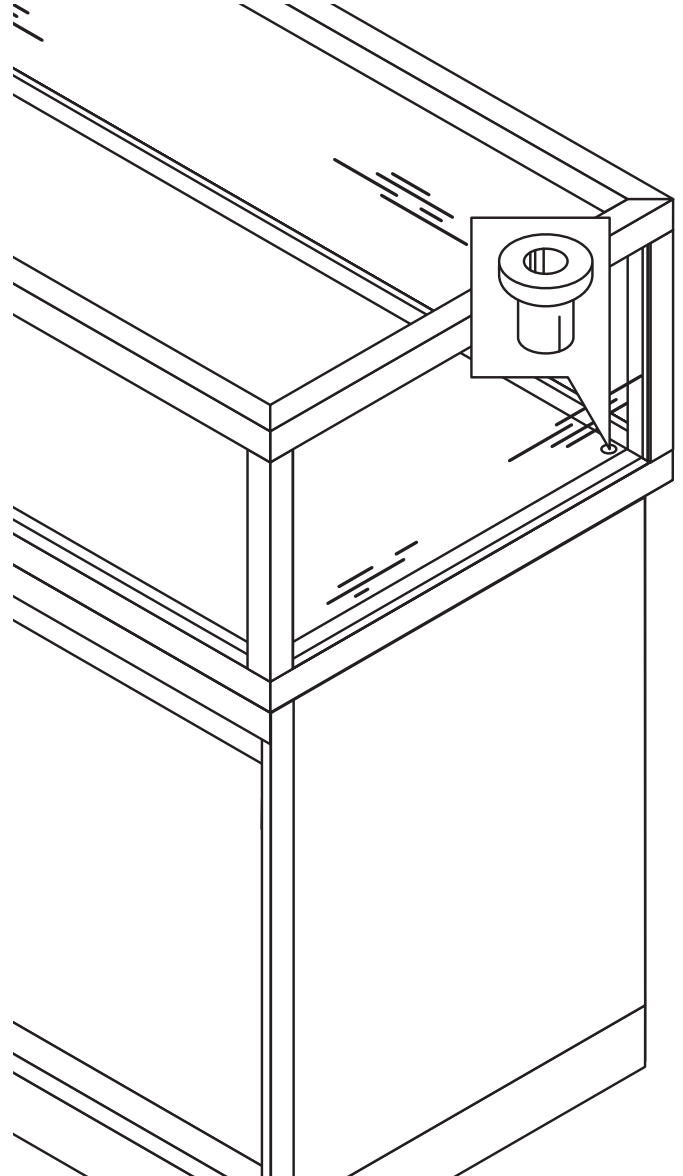
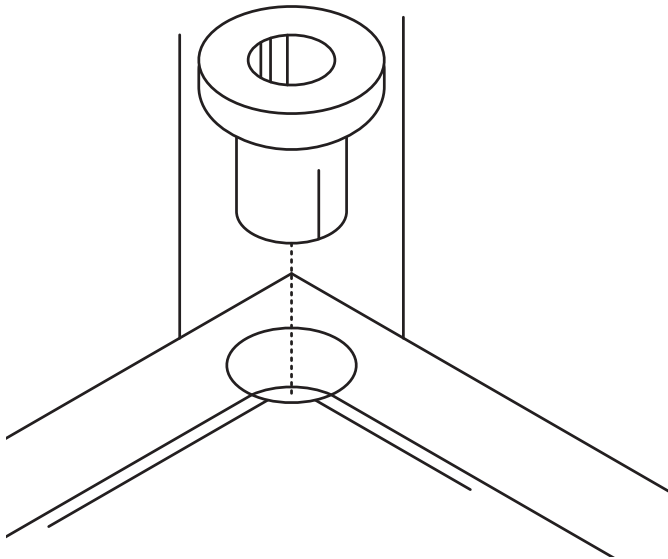

### STEP 5

THREAD THE EXCESS LED WIRE THROUGH THE TUBE COVER.

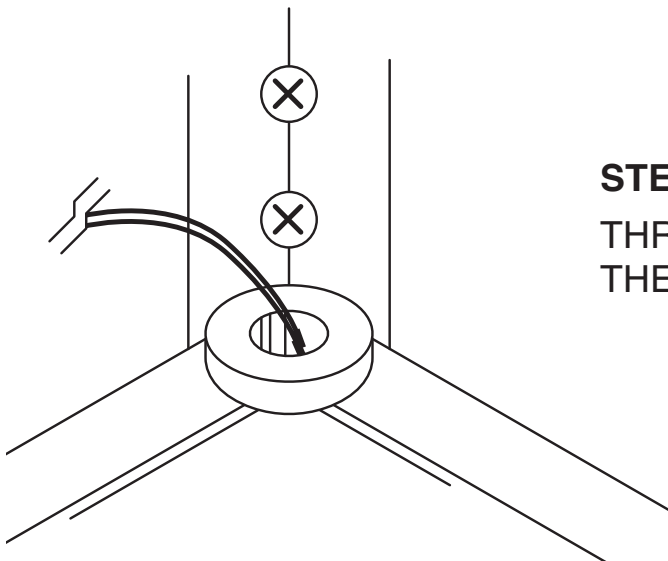

# ASSEMBLY INSTRUCTIONS MANUAL

## 65847 65848 - LED LIGHT KIT FOR 48" & 70" METAL FRAMED JEWELRY SHOWCASE

### STEP 6

CAREFULLY SLIDE IN THE LED TUBE ASSEMBLY INTO THE DISPLAY. ALIGN WIRE TUBE WITH TUBE COVER, SLIDE IN AND CLIP LED TUBE INTO PLACE.

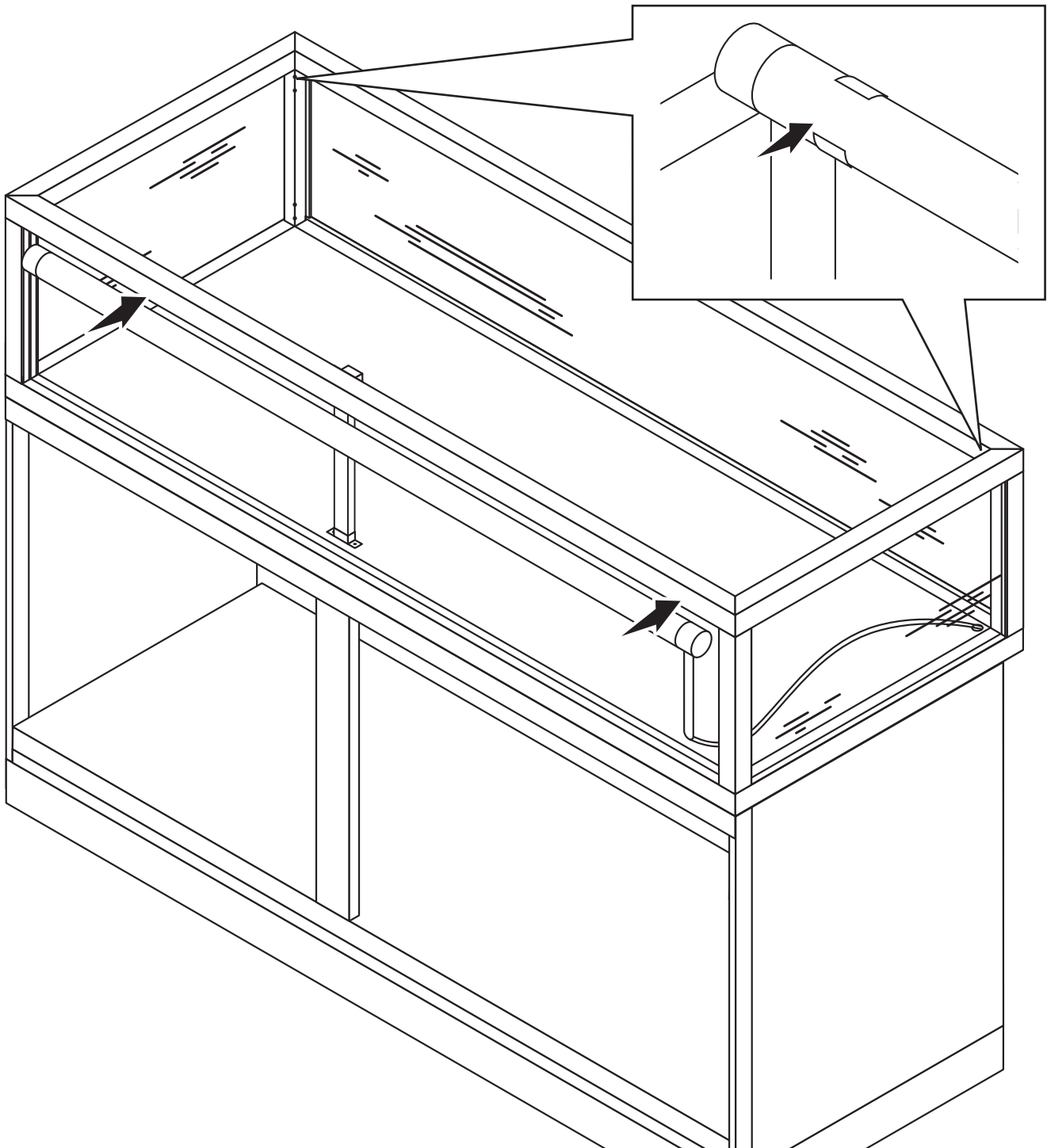

# ASSEMBLY INSTRUCTIONS MANUAL

## 65847 65848 - LED LIGHT KIT FOR 48" & 70" METAL FRAMED JEWELRY SHOWCASE

### STEP 7

TO COMPLETE THIS INSTALLATION, THE DISPLAY WILL NEED TO BE ACCESSED FROM THE BOTTOM. PLACE THE TRANSFORMER BRACKET OVER THE TRANSFORMER AND SCREW (#2 SCREWS) INTO PLACE WITH THE PRE-DRILLED HOLES . **DO NOT OVER TIGHTEN.**

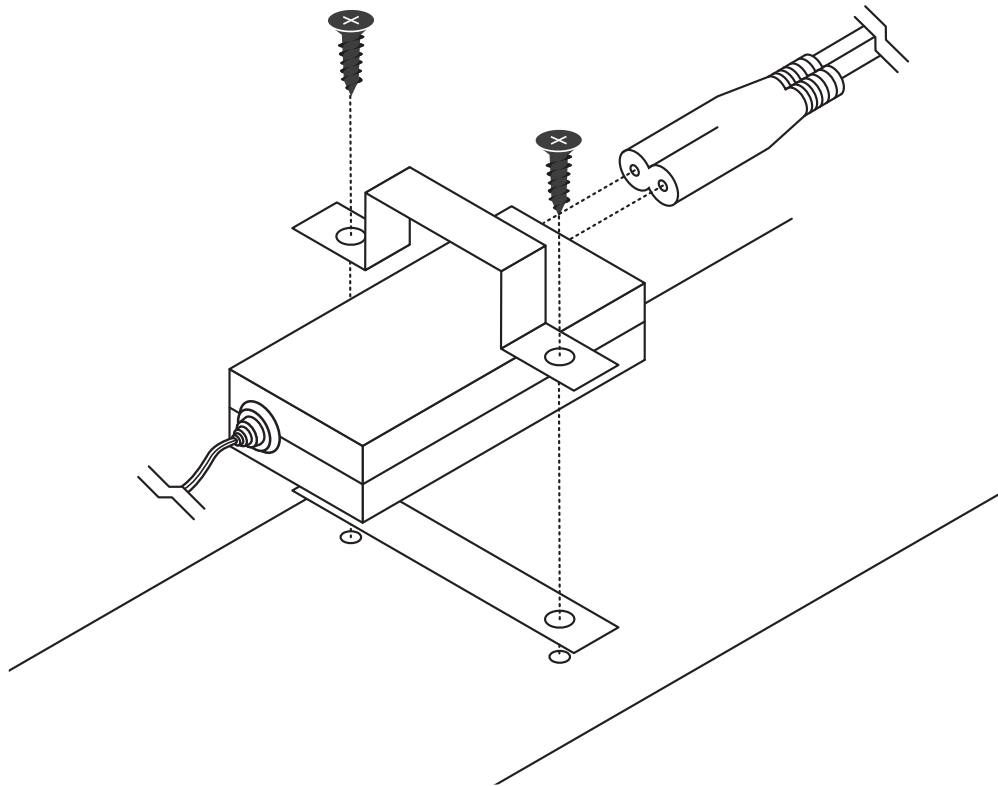

### STEP 8

LASTLY, SLIDE THE BARE WIRES INTO THE WIRE CLIPS, THEN CONNECT. **(NOTE: THE WIRES CAN BE ON EITHER SIDE)** INSTALLATION IS COMPLETE.

